

ONEIDA COUNTY FOREST FIREWOOD AREA

ONEIDA COUNTY FOREST-TIMBER SALE

Good Cinder Hwd Sale

CMPT / STAND: 23 / 17
 CUTTING AREA: 75 ACRES
 DESCRIPTION: T35N R9E, SEC. 33 SW1/4, SWNW,
 SEC, 32 NESE, SENE
 CONTRACT LENGTH: 2 YEARS
 Scale: 4 inches = 1 mile

TRACT # 5-17
 CONTRACT # _____
 TOWNSHIP OF: Enterprise
 CONTRACTOR: _____
 DATE SOLD: _____
 DATE COMPLETED: _____

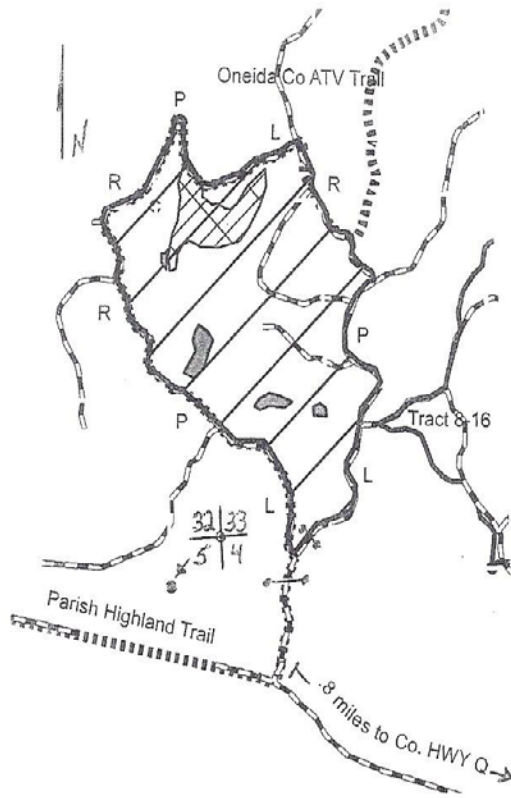

see location of description for Regan Area

4" TOP	Est. Volume	MIN BID
Mixed Hardwood * (~470 cords)	925 T	\$ 13.40 / Ton
Basswood (~70 cords)	70 T	\$ 3.20 / Ton
Hemlock/ Balsam Fir** (~35 cords)	60 T	\$ 3.00 / Ton
WHOLE TREE	Est. Volume	MIN BID
Mixed Hardwood*	1302 T	\$ 9.52 / Ton
Basswood	95 T	\$ 2.36 / Ton
Hemlock/Balsam Fir	140 T	\$ 1.29 / Ton

LOG VOLUMES	Est. Volume	Min Bid
Basswood Logs	37 MBF	\$149.00 / MBF
Sugar Maple Logs	35 MBF	\$298.00 / MBF
Mixed Hwd Logs***	23 MBF	\$177.00 / MBF
Red Oak Logs	9 MBF	\$298.00 / MBF

*Mixed Hwd Pulp--85%-Mh, 13%- Mr, 2%-Misc
 **Hemlock/Balsam Fir--60% Hemlock, 40% Balsam Fir
 *** Mixed Hwd Logs--50%-Mr, 30%-Bw, 20%-Misc

LEGEND

- RPL Red Paint Line
- ATV Trails
- Logging Roads
- Berm / Gate
- Swamp conifer/Keg
- Harvest Area

Firewood Harvest Regulations:

****ATV Access Only****

- Do not cut standing trees, dead or not.
- Harvest firewood only from tops and branches of logging debris.
- All roads and trails are to be kept free from branches and debris.

If you have any questions, contact Oneida County Forestry Dept at 715-369-6140