

ONEIDA COUNTY FOREST FIREWOOD AREA

Oneida County Forest Wash Trout Virus

Compartment 30 / Stands 1 & 26
 Harvest Area 35 Ac + 6 Ac Reserve = 41 Total Acres
 Legal Desc. T36N R7E Sec. 2 SWSE, SESW, NESW,
 Sec. 11 S1/2NE1/4, N1/2SE1/4, NENW



Tract # 22 -20
 Town of Woodboro
 Contract No.: _____
 Contractor: _____
 Date Sold: _____
 Date Completed: _____
 Contract Length: 3 years

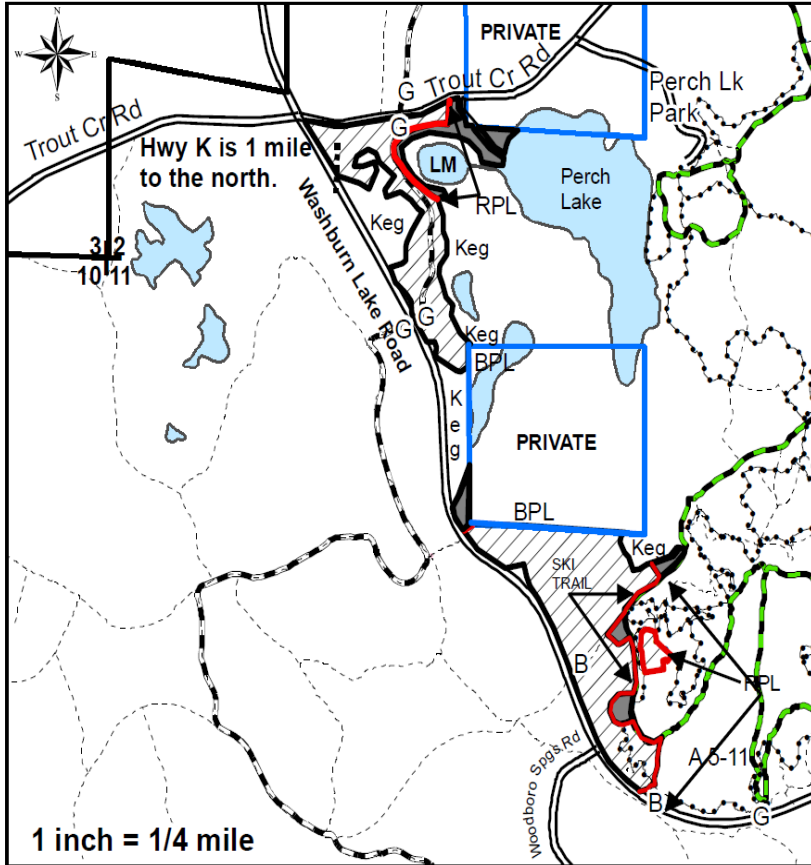

4" TOP	EST. VOLUME	MIN. BID
Aspen	1515 Tons (675 cd)	\$8.00/Ton
*Mx Hwd	475 Tons (200 cd)	\$7.70/Ton
WHOLE TREE	EST. VOLUME	MIN. BID
Aspen	2185 Tons (970 cd)	\$5.55/Ton
*Mx Hwd	775 Tons (325 cd)	\$4.72/Ton
EST. LOG VOLUME	MIN. BID	
OR	13 MBF	\$140.00/MBF

*Mx Hwd pulp includes: 71% red maple, 12% white birch, 16% red oak & 1% misc hardwoods.

Legend	
	Harvest Area
	Retention Area
G	Gate
B	Berm or Boulders
LM	Lake Minor
	Single Track Trail
	Ski Trail
BPL	Blue Paint Line
RPL	Red Paint Line
	Snowmobile Trail
	Section Corner
	Logging Road
	Town Road

Additional Regulations:

Firewood Harvest Regulations:

- Do not cut standing trees, dead or not.
- Harvest firewood only from tops and branches of logging debris.
- All roads and trails are to be kept free from branches and debris.

If you have any questions, contact Oneida County Forestry Dept at 715-369-6140.