

PUBLIC NOTICE
Invitation for Sealed Bids on Timber Stumpage

Sealed bids will be accepted by the Oneida County Forestry Department at the Oneida County Courthouse, Second Floor, Room B206, Rhinelander, WI 54501 **UNTIL NOON ON THURSDAY, May 9, 2024**. A timber sale prospectus and bid forms may be obtained by contacting the Forestry Office at the above address or by telephone at (715) 369-6140. Bid packets can be viewed online at <http://www.oneidacountywi.gov>

Oneida County Forest is third party Certified. For information regarding certification, please contact the Forestry Office.

There are 16 tracts of timber for sale in the Towns of Enterprise, Little Rice, Lynne, and Woodboro, comprising approximately 1,336 acres. Total volume estimates are as follows:

Aspen	17,020 Tons /	7,556 Cds	Spruce, White	110 Tons /	55 Cds
Balsam Fir	680 Tons /	324 Cds	-----		
Basswood	1,320 Tons /	681 Cds	Basswood Logs	110 MBF	
Mixed Hwd	19,850 Tons /	8,153 Cds	Hard Maple Logs	85 MBF	
Oak, Red	510 Tons /	185 Cds	Mixed Hwd Logs	202 MBF	
Pine, Red	4,145 Tons /	1,840 Cds	Red Oak Logs	52 MBF	
Pine, White	150 Tons /	70 Cds			

The outside of the envelope must show the tract number and contractor name. Bids must include:

1. Tract number.
2. List of species to be cut and estimated volume.
3. Bid prices per Ton or MBF for each species and product.
4. Signature and address of each bidder.
5. A refundable bid bond in the form of check or cash must accompany each bid for the amount of 5% of the total bid value.

Successful bidders must provide proof of training to the State SFI standards and a completed Wisconsin Sales and Use Tax Exemption Certificate (form S-211) to the county at the time of contract signing. Minimum required deposit is 25% of successful bid value for each tract. The Forestry, Land & Recreation Committee reserves the right to reject any or all bids and/or select the bid most advantageous to Oneida County.

Bids will be publicly opened Thursday, May 9, 2024 at 1:00 p.m. in Committee Room #1, 2nd Floor, Oneida County Courthouse, Rhinelander, WI. Successful bids will be awarded at the regularly scheduled Oneida County Forestry, Land & Recreation Committee meeting at 8:00 a.m. on Tuesday, May 14, 2024 in the County Board Room, 2nd floor, Oneida County Courthouse Rhinelander, WI. Bid results will be posted online at www.oneidacountywi.gov/departments/fr/timber-sales/)

NOTICE FOR SEALED BIDS FOR STUMPAGE ON
ONEIDA COUNTY FOREST LANDS

BID DEADLINE: May 9, 2024 at NOON

Sealed bids will be received by the Oneida County Forestry Committee for the purchase of stumpage on the attached maps of Oneida County Forest Land, in accordance with the conditions set forth by the Committee. Additional information about the cutting areas is available from the Oneida County Forestry Office, PO Box 400, Rhinelander, WI 54501.

A REFUNDABLE BID BOND (CASH OR CHECK), IN THE AMOUNT OF 5% OF THE TOTAL BID VALUE, MUST ACCOMPANY EACH BID.

If your bid is NOT SELECTED, the bid bond will be returned. If your bid is ACCEPTED, your bid bond will be held until the contract is signed on the terms below. If the contract is not signed within the required two (2) week period, your bid bond will be FORFEITED.

12.5 % will be added to the scale of all hand peeled wood. 16% will be added to the scale of all machine peeled wood.

SCALE PAYMENT WILL BE BY THE LOCK BOX HAUL PERMIT SYSTEM.

Irrevocable Letters of Credit and bonds will be considered on an individual basis in lieu of cash deposits.

Letters of Credit must have an expiration date one year past the contract end date.

Certificates of Insurance will be provided by the successful bidder at the signing of the contract, proving adequate liability with the limits of \$1,000,000 bodily injury and \$1,000,000 property damage and Worker's Compensation at statutory limits.

All successful bidders must provide proof of training to the State SFI standards and a completed Wisconsin Sales and Use Tax Exemption Certificate (formS-211) showing tax exemption status at contract signing.

Successful bidders must sign contracts and pay balance of deposit within two weeks of receipt. Contract expiration dates vary from one to four years and may be renewed, with increased rates, at the discretion of the Committee. Total contract period shall be no more than four years from date issued. Upon signing of the contract, a deposit of 25% of the total successful bid value will be required. The minimum rates only apply to jobs sold by competitive bidding.



It is the bidder's responsibility to contact individual towns to determine if there are town ordinances relating to logging operations on town roads. Town contact information can be found on the Oneida County website (www.oneidacountywi.gov) under "Municipalities" or by contacting the Oneida County Clerk at 715-369-6144.

PLEASE NOTE: Oneida County Forest Roads (Bowman Rd, John's Memorial Dr, Zimmer Rd, Shingle Mill Rd, Camp Six Rd, South Exit Rd, Bass Lake Rd, Cruisers Rd and Rozell Rd) are *not maintained in the winter by the County*. It is the responsibility of the Contractor to arrange snow plowing on these roads.

ALL BIDS MUST MEET MINIMUM BID PRICE PER SPECIES AS STATED ON SALE MAPS.

Note: Log specifications - Small end: 10” diameter inside the bark for hardwood and 9” diameter inside the bark for softwoods and capable of making a #3 Grade log. All logs shall be scaled by the County prior to hauling.

NOTE: Bids will be publicly opened on Thursday, May 9, 2024 at 1:00 p.m. in Committee Room #1, 2nd Floor, Oneida County Courthouse, Rhinelander, WI. Successful bidders will be announced Tuesday, May 14, 2024 at the regularly scheduled Forestry Committee meeting, scheduled to begin at 8:00 a.m. in the County Board Room, 2nd Floor, Oneida County Courthouse, Rhinelander, WI. Bid results will be posted online at www.oneidacountywi.gov/departments/fr/timber-sales/)

BID DEADLINE: **Thursday, May 9, 2024 at NOON**; Oneida County Forestry Office; PO Box 400, Court House, 2nd Floor, Room B206, Rhinelander, WI 54501.

If you would like to be removed from our stumpage mailing list, complete the information below and return it to:

Oneida County Forestry Department
PO Box 400
Rhinelander WI 54501

NO, I do not wish to remain on the stumpage mailing list. Please remove my name.

NAME: _____

MAILING ADDRESS: _____

CITY / STATE / ZIP: _____

ONEIDA COUNTY FORESTRY DEPARTMENT
TIMBER SALE BID FORM

Send completed bids and bid bonds to: Oneida County Forestry, Land & Outdoor Recreation Committee, PO Box 400, Rhinelander, WI 54501

All sales are subject to the following conditions:

1. Only the tree species specified on the timber sale prospectus / map are to be cut. Utilization specifications designated for the sale area must be adhered to.
2. Contractor must comply with Slash Disposal Law, Sec.26.12(b), Wisconsin Statutes.
3. A Refundable Bid Bond must accompany each bid. Bid bond will be of 5% of the total bid value, in the form of a check or cash. A Performance Bond, in the form of cash, check, or letter of credit, equaling 25% of the total bid value is due upon signing of the contract.
4. No forest products shall be removed until scaled and marked by a representative of the Forestry Department and paid for unless otherwise specified in the contract scaling instructions. **NOTE: Log specifications - Small end: 10" diameter inside the bark for hardwood and 9" inside the bark for softwoods and capable of making a #3 grade log.**
5. All timber, marked or otherwise designated by the contract to be cut, shall be cut progressively and to the satisfaction of the representative of the Forestry Department, whether or not the quantity of such timber is more or less than the estimated comprising the operational specifications.
6. Undesignated trees cut or injured through carelessness and designated trees left through carelessness shall be paid for at double the stumpage rate. Timber wasted in tops and stumps shall be paid for at the stumpage rate.
7. Purchaser agrees to assume all liability for any damage or injury to persons or property, real or personal, resulting from Purchaser's operations under this contract and will hold Oneida County harmless from the same. The contractor shall furnish certification to the Oneida County Forestry Department that he / she is adequately insured with a reliable company so that Oneida County shall not be held liable in case of injury or death during and after the contract period. The limits of liability shall be \$1,000,000.00 bodily injury and \$1,000,000.00 property damage. The contractor shall also furnish proof of Workers Compensation Insurance at statutory limits. In the event the Purchaser's insurance is terminated for any reason, he / she shall immediately cease all activities otherwise permitted by the contract and provide written notice to the Forestry Department.
8. Roadways and trails will be kept free from brush, logs, pulp and waste material resulting from the operation. The Purchaser must abide by all rules regarding the use of roads, trails, and fire lanes. Additional constructed roads or trails must meet the approval of the Forestry Department.
9. Contractors will be required to furnish the Forestry Department with proof of SFI Logger Certification and a completed Wisconsin Sales and Use Tax Exemption Certificate (form S-211) showing tax exemption status prior to signing contracts.

TURN OVER FOR SIDE 2

10. If, in the opinion of the Forestry Department, it is deemed that Contract provision are not being adhered to, all logging operations will be suspended. Operations may not be resumed without notification of the Forestry Department.
11. The Forestry Committee shall be the sole judge as to satisfactory compliance of contract conditions.
12. Timber sale contracts cannot be assigned in whole or in part without the consent of the Forestry Committee.
13. Any or all bids may be rejected by the Committee.
14. ALL BIDS PER SPECIES MUST MEET MINIMUM BID PRICE AS STATED ON PROSPECTUS.
15. Sample copies of County timber sale contracts are available for review at the Forestry Office in the Oneida County Court House.
16. All contracts will expire after the term indicated on the sale prospectus / map. One year extensions may be granted at the discretion of the Forestry, Land & Recreation Committee. Stumpage rates will be increased according to the following schedule:

One Year Contract:	1st Extension 5% rate increase 2nd Extension 10% rate increase 3rd Extension 15% rate increase
Two Year Contract:	1st Extension 10% rate increase 2nd Extension 15% rate increase
Three Year Contract:	1st Extension 15% rate increase (No additional extensions)

Total contract period, plus extensions, shall be no more than four years from date issued.

NOTE: The number of bids received per tract will not be revealed prior to bid deadline.

NOTE: Each tract that is bid on will be placed in a sealed envelope marked "Sealed Bid--Tract #__" and have the contractors name and address plainly printed on the front of the envelope.

BIDDER'S NAME, ADDRESS AND TRACT NUMBER MUST BE INCLUDED ON THE OUTSIDE OF THE ENVELOPE.

I submit the following bid on TRACT # _____.

Utilization Specifications being Bid (**circle one**) 4" Top Whole Tree

Note: Make sure to use the volume estimates corresponding to the utilization specifications being bid. Bids must be per ton unless minimum bid is listed only by mbf or cords.

SPECIES	EST. VOLUME	BID/UNIT	SPECIES TOTAL
TOTAL BID			\$
Bid Deposit (5% of Bid Total) – Include with Bid:			\$
Performance Bond (25% of Bid Total) – Due at Contract Signing:			\$

I am aware that 12.5% will be added to the scale of hand-peeled pulpwood and 16% will be added to the scale of machine-peeled pulpwood. I am also aware the schedule of payment for all wood removed will be specified by the Committee on each individual contract.

Date: _____

Bidder's Name / Company (Please Print): _____

Mailing Address: _____

City, State, Zip Code: _____

Telephone Number: _____

Email Address: _____

Bidder's Signature: _____

Tract Number: _____

Conversion Rates used by Oneida County

<i>SPECIES</i>	<i>GREEN WEIGHT</i>		
	<u>lb/cd</u>	<u>Tons/cd</u>	<u>Tons/mbf</u>
Ash (Ab)	4600	2.30	5.06
Aspen (A)	4500	2.25	4.95
Balsam Fir (Fb)	4250	2.13	5.20
Basswood (Ba)	3850	1.93	4.25
Birch, White (Bw)	4800	2.40	5.28
Birch, Yellow (By)	5350	2.68	5.90
Cedar (C)	3150	1.58	3.86
Hemlock (H)	4800	2.40	5.86
Maple, Hard (sugar) (Mh)	5100	2.55	5.61
Maple, Red (Soft) (Mr)	4550	2.28	5.02
Mixed Hardwood (Mx)	4900	2.45	5.39
Oak, Red (Or)	5500	2.75	6.05
Pine, Jack (Pj)	4250	2.13	5.20
Pine, Red (Pr)	4500	2.25	5.49
Pine, White (Pw)	4200	2.10	5.13
Spruce (Sw, Sb)	4000	2.00	4.88
Tamarack (T)	4650	2.33	5.69

Compartments / Stand 71/12
 Harvest Area: 36 ac.
 Legal Desc. Sec 1: NESW,
 NESE, SENE; T36N R4E

Oneida County Forest Tall Bass Hardwood

Tract # 1-24
 Town of Lynne
 Contract No.: _____
 Contractor: _____
 Date Sold: _____
 Date Completed: _____
 Contract Length: 3 years

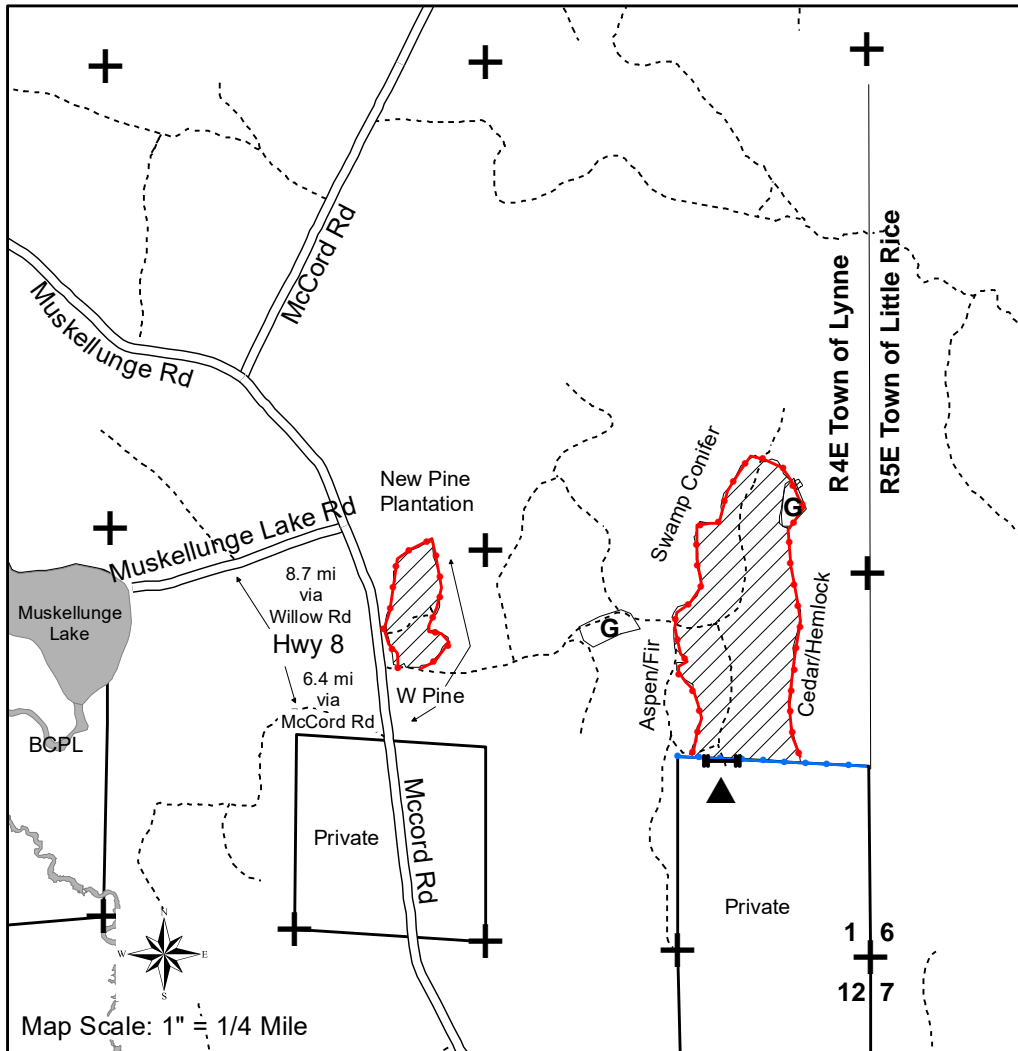

4" Top	Est Vol	Min Bid
Mx Hwd*	350 Tons (143 cd)	\$6.90/T
Basswood	110 Tons (55 cd)	\$2.10/T
Balsam Fir	55 Tons (25 cd)	\$3.50/T
Sawlogs		
Mx Hwd**	9 MBF	\$119.00/mbf
Basswood	30 MBF	\$98.00/mbf
*Mx Hwd Pulp = 60% H Maple, 14% Ash, 26% R Maple **Mx Hwd Logs = 53% R Maple, 19% H maple, 28% Ash		
Whole Tree	Est Vol	Min Bid
Mx Hwd*	425 Tons (173 cd)	\$5.68/T
Basswood	120 Tons (60 cd)	\$1.93/T
Balsam Fir	55 Tons (25 cd)	\$3.50/T
Sawlogs		
Mx Hwd**	9 MBF	\$119.00/mbf
Basswood	30 MBF	\$98.00/mbf
*Mx Hwd Pulp = 60% H Maple, 14% Ash, 26% R Maple **Mx Hwd Logs = 53% R Maple, 19% H maple, 28% Ash		
Legend		
	Blue Paint Line	
	Harvest Area	
	Survey Corner	
	Logging Road	
	Town Road	

Additional Regulations:

- In the Harvest Area cut all Balsam Fir and Ironwood 1 inch dia or larger and only those hardwood trees marked with orange paint leaving orange visible on the stump. Trees that are completely blown down may be harvested. Do not cut Aspen. Utilization on all species is a 100" stick to a 4" top or Whole Tree. If harvesting whole tree, 1 in 10 tops above the standard 4" top shall be left evenly scattered throughout the stands. Damage to established regeneration must be minimized. If excessive damage to the hardwood regeneration occurs, additional restrictions may be imposed or the contract may be canceled.
- Any den or nest trees shall be left uncut. Standing dead trees are not to be cut unless they pose a safety hazard.
- Harvesting and skidding are limited to the period from July 15 to the following March 15 (spring breakup) and only when the ground is dry or frozen enough to prevent rutting. Additional time restrictions may be imposed if excessive rutting occurs in the woods, on the roads, or if excessive damage to the residual trees occurs. No skidding north out of the west part of the sale to protect the newly planted pine and an archaeological site.
- No new roads will be permitted. Existing roads may be opened and improved and landing sites may be constructed with prior approval of the County. All trails/roads and landings will be returned to their original condition or better at the end of the sale. The main access road is also used as access to the private property to the south of the east part of the sale. This road must be kept in good, drivable condition at all times and may not be blocked to prevent vehicle travel at any time. The road may not be used during wet ground conditions to prevent rutting of the road. The road must be returned to its original condition or better at the end of each harvest season and at the end of the sale. Bond money will not be returned until all road/landing rehabilitation is complete. The grass/brush openings may be used for landings. If topsoil is removed from the openings, it must be replaced and graded smooth.
- No equipment or slash is allowed in the wetland areas within or adjacent to the sale. Equipment may not be operated within 15 feet of any wetland unless ground is dry or frozen. All trees are to be pulled back onto the sale area from across the blue line prior to limbing.
- All items listed in the Oneida County Timber Sale Contract apply. All applicable BMP's will be followed. Sale Est. PF OCF DNR 11/23

Oneida County Forest Riverview Hardwood

Compartment / Stand 100/16
Harvest Area: 152 Ac
Legal Desc. T37N R4E
Sec. 5 NW1/4, N1/2SW
Sec. 6 NWNE, E1/2NE, NESE

Tract # 2-24
Town of Lynne
Contract No.: _____
Contractor: _____
Date Sold: _____
Date Completed: _____
Contract Length: 3 years

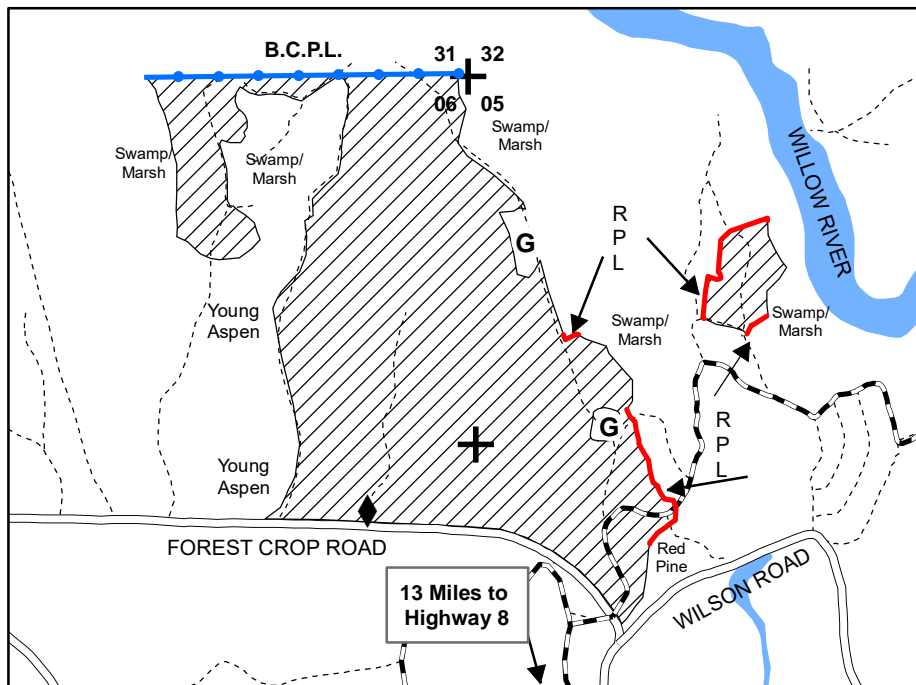

1 inch = 1/4 mile

4" Top	Est. Volume	Min. Bid
*MX Hardwood	2950 Tons (1200 cd)	\$9.00/Ton
Basswood	260 Tons (134 cd)	\$2.70/Ton
Fir	30 Tons (15 cd)	\$4.50/Ton
Logs		
**MX Hwd	148 MBF	\$135.00/MBF
Basswood	62 MBF	\$113.00/MBF
Hard Maple	61 MBF	\$203.00/MBF
Red Oak	29 MBF	\$180.00/MBF
*MX Hardwood Pulp contains approximately: 57% H Maple, 22% Ash, 19% R Maple, 1% W Birch, 1% Aspen		
**MX Logs: 80% Ash, 20% R Maple		

Legend

- Marked Harvest
- Blue Paint Line (BPL)
- Red Paint Line (RPL)
- Woods Road
- Town Road
- Survey Corner
- Grass Opening
- Rocks/Berm
- Snowmobile Trail

Additional Regulations:

- In the Marked Harvest Area cut all trees marked with orange paint, leaving orange visible on the stump, AND all Fir and Ironwood over 1" DBH. Extreme caution must be used to protect existing regeneration. Excessive damage to regen may result in further equipment restrictions (such as no hot saws), or contract cancellation. Utilization on all species is a 100" stick to a 4" top. NO WHOLE TREE OR POLE LENGTH SKIDDING. Any den or nest trees shall be left uncut. Standing dead trees are not to be cut unless they pose a safety hazard.
- Dry or frozen ground conditions will be required for harvesting and hauling activities. Harvesting operations are limited to July 15th to the following spring breakup period. Further time restrictions may be imposed if excessive rutting occurs in the woods or on the roads or if excessive damage to the residual trees occurs.
- New roads may be permitted with prior approval of the county. Existing roads may be opened and improved and landing sites may be constructed with prior approval of the County. Roads must be leveled and left in as good or better condition at the end of the sale. Roads must be blocked with berms or rocks at the end of each harvest season and at the end of the sale if they were previously blocked. Bond money will not be returned until all road/landing rehabilitation is complete.
- No equipment or slash is allowed in the wetland areas within or adjacent to the sale. Equipment may not be operated within 15 feet of any wetland unless ground is dry or frozen. If grass opening is used as a landing it must be graded smooth with all top soil returned to disturbed areas. Survey corner and bearing trees are painted BLUE. DO NOT CUT/DAMAGE BEARING TREES OR SURVEY MONUMENT.
- Slash must be pulled back a minimum of 25 ft from the edge of the Town roads and must be cut to no higher than 2 ft off the ground within 50 ft of the road. Decking or skidding on the Town roads is prohibited unless permission is obtained from the Town of Lynne. The road must be repaired to the satisfaction of the Town if it is used for skidding or decking.
- The snowmobile trail must be kept open, snow covered and in a safe useable condition during the snowmobile season. The trail shall be returned to its original condition or better at the end of the sale. Cautionary signs must be placed at both ends of the trail if used during snowmobile season. Slash must be pulled back 10 ft from the edge of the trail and cut to less than 2 ft within 25 ft of the trail.
- All items listed in the Oneida County Timber Sale Contract apply. All applicable BMP's will be followed. Sale Est. JT/OCF/DNR 11/23

Oneida County Forest Monster Mash Hardwood

Compartment / Stand 100/18
 Sale Area: 111 Acres
 Legal Desc. T37N R4E Sec. 6 NW1/4,
 NWNE



Tract # 03-24
 Town of Lynne
 Contract No.: _____
 Contractor: _____
 Date Sold: _____
 Date Completed: _____
 Contract Length: 3 years

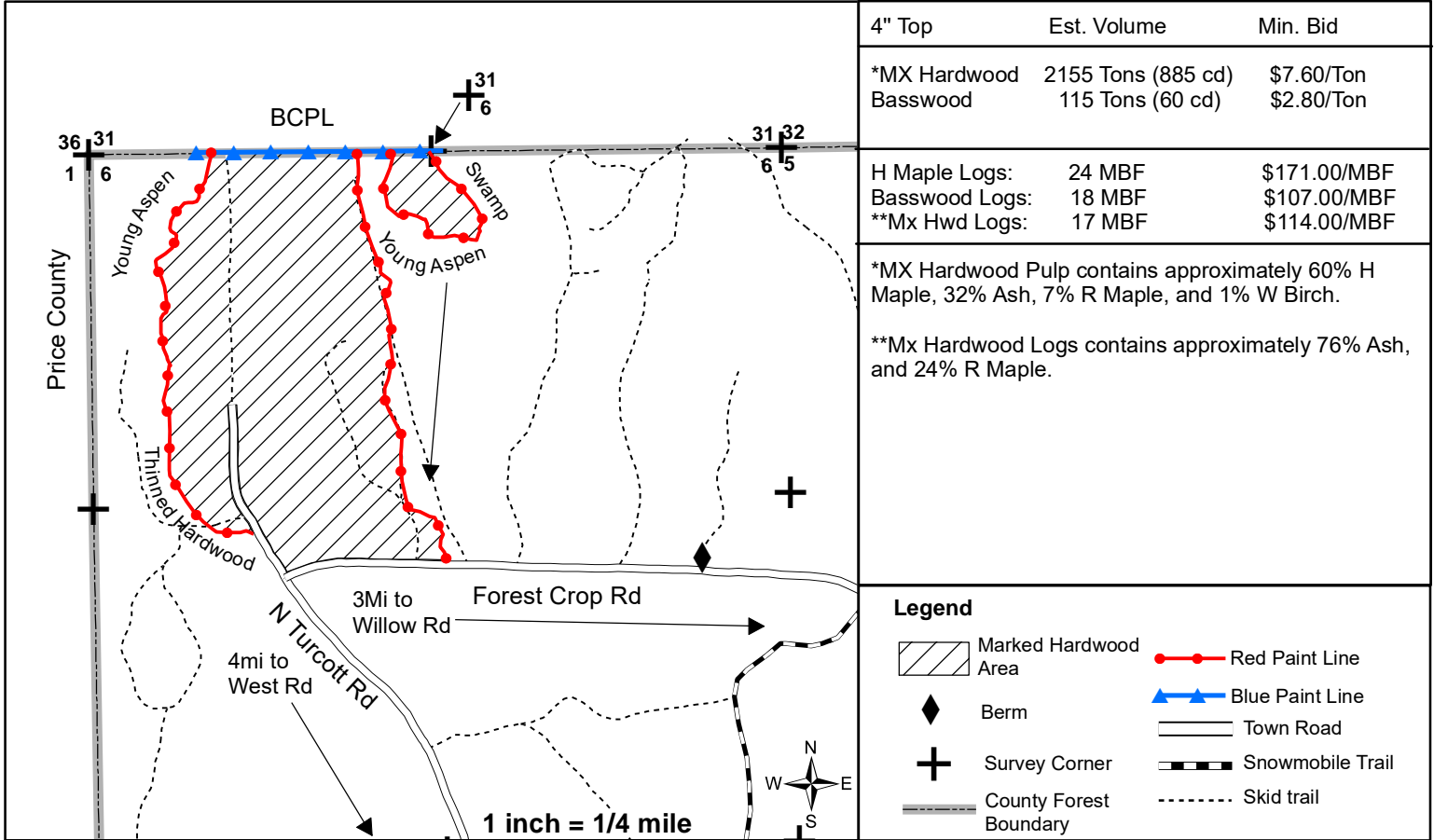

4" Top	Est. Volume	Min. Bid
*MX Hardwood Basswood	2155 Tons (885 cd) 115 Tons (60 cd)	\$7.60/Ton \$2.80/Ton
H Maple Logs: Basswood Logs: **Mx Hwd Logs:	24 MBF 18 MBF 17 MBF	\$171.00/MBF \$107.00/MBF \$114.00/MBF
*MX Hardwood Pulp contains approximately 60% H Maple, 32% Ash, 7% R Maple, and 1% W Birch.		
**Mx Hardwood Logs contains approximately 76% Ash, and 24% R Maple.		

Legend

- Marked Hardwood Area
- Red Paint Line
- Blue Paint Line
- Berm
- Survey Corner
- County Forest Boundary
- Town Road
- Snowmobile Trail
- Skid trail

Additional Regulations:

1. In the **Marked Hardwood Area** harvest all ironwood 1" or larger, all ash with 1 or more sticks to a 4" top (regardless of if it is painted or not), and all trees marked with orange paint, leaving orange visible on the stump. Do not cut aspen or balsam fir. **EXTREME CAUTION** must be used to protect existing hardwood regeneration. Excessive damage to regen may result in further equipment restrictions (such as no hot saws or fixed head harvesters only), or contract cancellation. Slash must be evenly distributed across sale area (no large piles). Slash should not be concentrated in canopy gap areas. **NO WHOLE TREE OR POLE LENGTH SKIDDING**. Utilization on all species is a 100" stick to a 4" top. No whole tree harvesting is allowed. Any den or nest trees shall be left uncut. Standing dead trees are not to be cut unless they pose a safety hazard.
2. Dry or frozen ground conditions will be required for harvesting and hauling activities. Harvesting/skidding in the harvest area is limited to July 15th through the following spring break-up (approx March 15th). Further seasonal restrictions may be imposed if excessive rutting occurs in the woods, the roads, or if excessive damage to the residual trees occurs.
3. No new roads are permitted except for accessing the eastern piece. Existing roads may be opened and improved and landing sites may be constructed with prior approval of the County. Access roads connecting to Forest Crop Rd must be blocked with berms/rocks or a gate at the end of each harvest season and at the end of the sale. All trails must be returned to their original condition or better at the end of sale operations. Bond money will not be returned until all road/landing rehabilitation is satisfactorily complete.
4. No equipment is allowed in the wetland areas adjacent to the sale unless the ground is frozen. No slash is to be left in any wetlands adjacent to the sale. Equipment may not be operated within 15 ft of any wetland unless ground is dry or frozen.
5. The survey monument on the NE corner of the eastern piece must not be disturbed and trees with blue paint on them shall not be cut. Any trees felled across the BPL must be pulled back completely onto county property prior to limbing.
6. Slash must be pulled back 25 ft off the edge of N Turcott and Forest Crop Rd and cut to less than 2 ft high within 50 ft of the roads.
7. N Turcott Rd and Forest Crop Rd are open to ATV/UTV traffic. Caution signs shall be installed on the roads to notify users of harvest operations.
8. All items listed in the Oneida County Timber Sale Contract apply. All applicable BMP's will be followed. Sale Est. JF/OCF/WDNR 11/23

Compartment / Stand 74/4
 Total Acreage: 28 ac
 26 Acres Harvest, 2 Acres Retention
 Legal Desc. T36N R5E
 Sec. 22 E1/2SE. SENE

Oneida County Forest White Rabbit

Tract # 4-24
 Town of Little Rice
 Contract No.: _____
 Contractor: _____
 Date Sold: _____
 Date Completed: _____
 Contract Length: 3 years

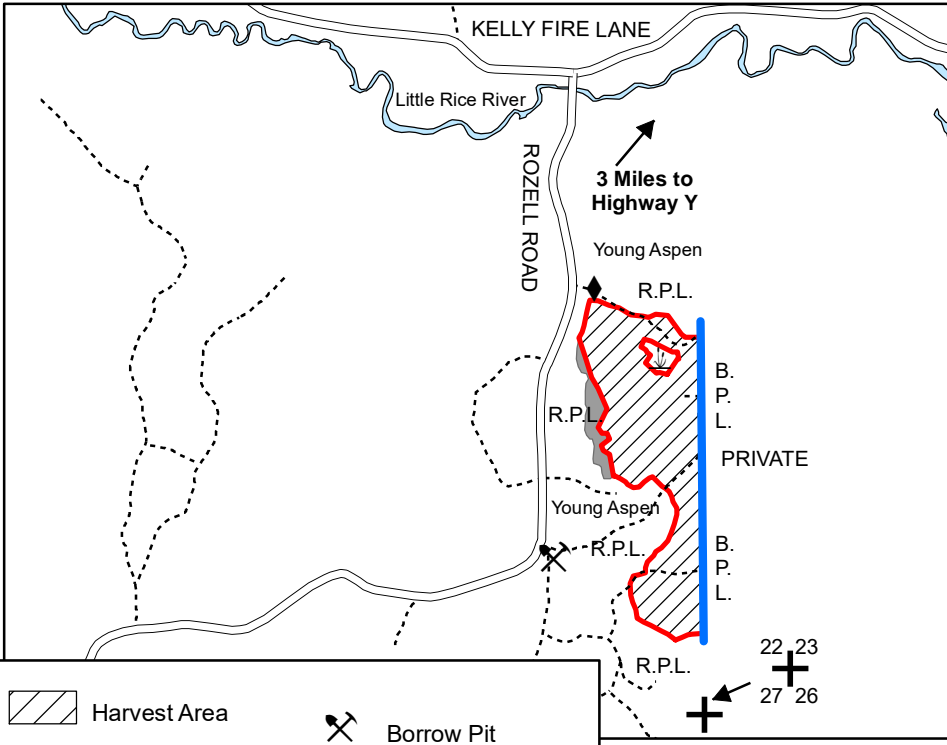

	Harvest Area		Borrow Pit
	Road		Survey Corner
	Retention Area		Rocks/Berm
	Blue Paint Line (B.P.L.)		Woods Roads
	Red Paint Line (R.P.L.)		Tag Alder

4" Top	Est. Volume	Min. Bid
Aspen	450 Tons (200 cd)	\$10.80/Ton
*MX Hardwood	965 Tons (395 cd)	\$8.10/Ton
**Fir/Spruce	175 Tons (85 cd)	\$4.10/Ton
LOGS		
**MX	19 MBF	\$135/MBF
Whole Tree	Est. Volume	Min. Bid
Aspen	630 Tons (280 cd)	\$7.72/Ton
*MX Hardwood	1420 Tons (580 cd)	\$5.50/Ton
**Fir/Spruce	175 Tons (85 cd)	\$4.10/Ton
LOGS		
**MX	19 MBF	\$135/MBF
*MX Hardwood Pulp contains approximately: 67% R Maple, 20% W Birch, 13% Ash		
**Fir/Spruce: 66% Fir, 34% Spruce		
**MX LOGS contains approximately: 52% R Maple, 33% W Birch, 15% Ash		

Additional Regulations:

- In the Harvest Area: cut all trees 1" dbh and larger EXCEPT Oak, Cedar, Yellow Birch, White Pine, Ash < 6" DBH and Spruce >16" dbh. Utilization on all species is a 100" stick to a 4" top or whole tree. If harvesting whole tree, every 10th tree top above the 4" diameter must be left evenly scattered in the harvest area. Any den or nest trees shall be left uncut. Standing dead trees are not to be cut unless they pose a safety hazard.
- Extremely dry or frozen ground conditions will be required for harvesting and hauling activities. Harvesting is allowed year-round. Time restrictions may be imposed if rutting occurs in the woods or on the roads or if excessive damage to the residual trees occurs.
- No new roads will be permitted. Existing woods roads may be opened and improved and landing sites may be constructed with prior approval of the County. All roads will be returned to their original condition or better at the end of sale. Roads must be bermed/rocked after each harvest season and at the end of the sale. Bond money will not be returned until all road/landing rehabilitation is complete.
- No equipment or slash is allowed in the wetland areas within or adjacent to the sale. Equipment may not be operated within 15 feet of any wetland unless ground is dry or frozen.
- Trees felled across BPL must be pulled back into the sale area prior to limbing.
- Decking on Rozell Road will only be allowed with the permission of the Oneida County Forestry Department. Any damage to the road will be immediately repaired by the contractor to the satisfaction of the Forestry Department.
- All items listed in the Oneida County Timber Sale Contract apply. All applicable BMP's will be followed.

Oneida County Forest

95 Breakup

Compartment / Stand 95/1
 Total Acreage: 119 Ac
 111 Acres Harvest, 8 Acres Reserve
 Legal Desc. T36N R4E
 Sec. 6 W1/2 NW1/4, SWSE.
 Sec. 7 NW1/4, NWNE



Tract # 5-24
 Town of Lynne
 Contract No.: _____
 Contractor: _____
 Date Sold: _____
 Date Completed: _____
 Contract Length: 4 years

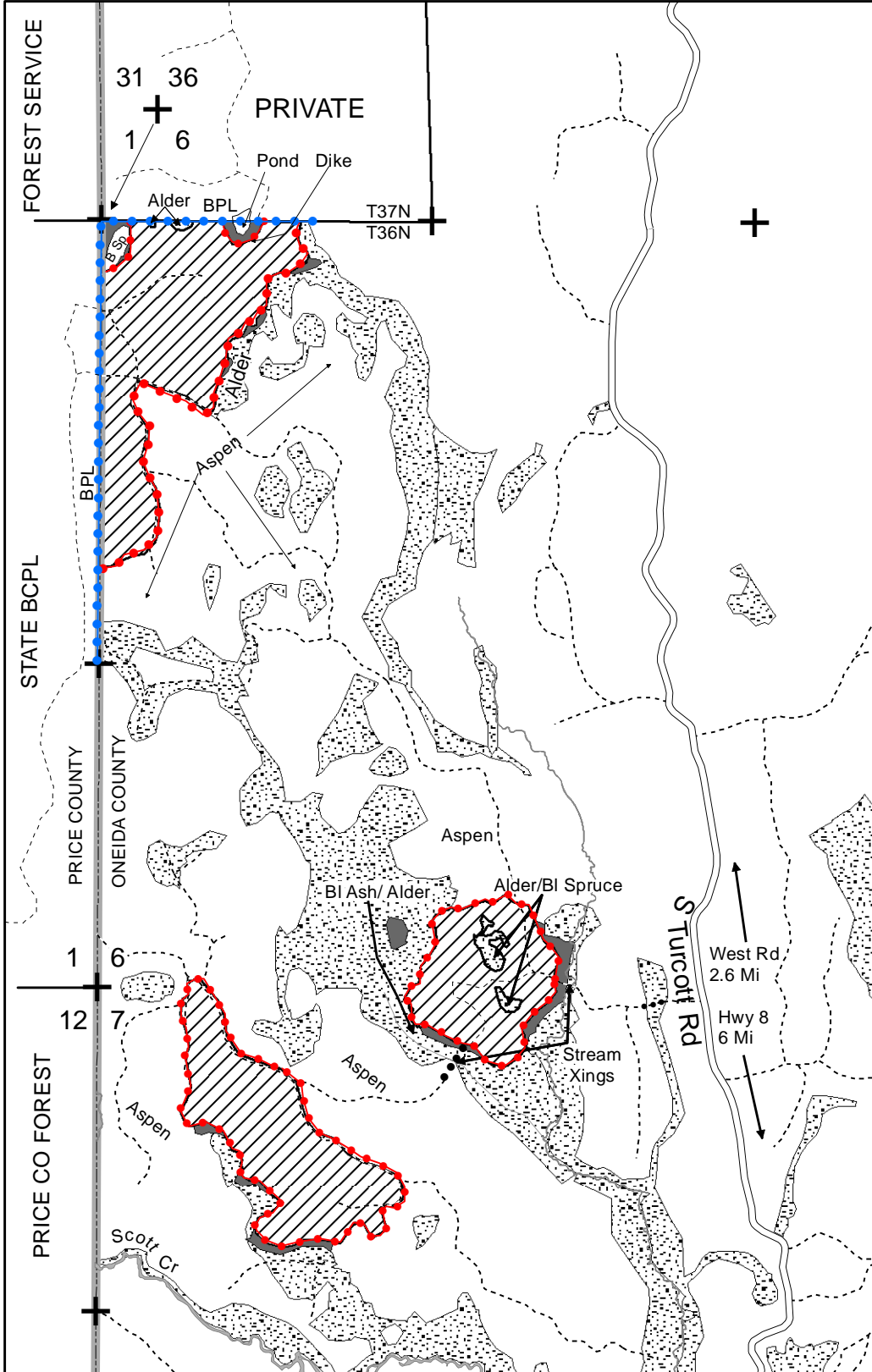

4" Top	Est. Volume	Min. Bid
Aspen	3455 Tons (1535 cd)	\$5.70/Ton
*MX Hwd	3370 Tons (1375 cd)	\$4.70/Ton
Fir	105 Tons (50 cd)	\$2.20/Ton

* Mx Hwd Pulp contains approximately 43% R Maple, 36% H Maple, 12% W Birch and 9% Ash

Whole Tree	Est. Volume	Min. Bid
Aspen	4660 Tons (2070 cd)	\$4.22/Ton
*MX Hwd	4730 Tons (1930 cd)	\$3.35/Ton
Fir	105 Tons (50 cd)	\$2.20/Ton

* Mx Hwd Pulp contains approximately 43% R Maple, 36% H Maple, 12% W Birch and 9% Ash

Harvest Area	Tag Alder/BI Ash Lowland
Retention Area	Survey Corner
Town Road	Wetland Crossing
Logging Rd/Trail	Red Paint Line
Stream	Blue Paint Line

**SEE REGULATIONS
PAGE 2**



1 inch = 1/4 mile

Oneida County Forest

95 Breakup

Compartment / Stand 95/1
Total Acreage: 119 Ac
111 Acres Harvest, 8 Acres Reserve
Legal Desc. T36N R4E
Sec. 6 W1/2 NW1/4, SWSE.
Sec. 7 NW1/4, NWNE



Tract # 5-24
Town of Lynne
Contract No.: _____
Contractor: _____
Date Sold: _____
Date Completed: _____
Contract Length: 4 years

**MAP ON
PAGE 1**



4" Top	Est. Volume	Min. Bid
Aspen	3455 Tons (1535 cd)	\$5.70/Ton
*MX Hwd	3370 Tons (1375 cd)	\$4.70/Ton
Fir	105 Tons (50 cd)	\$2.20/Ton
* Mx Hwd Pulp contains approximately 43% R Maple, 36% H Maple, 12% W Birch and 9% Ash		
Whole Tree	Est. Volume	Min. Bid
Aspen	4660 Tons (2070 cd)	\$4.22/Ton
*MX Hwd	4730 Tons (1930 cd)	\$3.35/Ton
Fir	105 Tons (50 cd)	\$2.20/Ton
* Mx Hwd Pulp contains approximately 43% R Maple, 36% H Maple, 12% W Birch and 9% Ash		

Additional Regulations:

1. In the Harvest Area cut all 1" diameter or larger Aspen, Maple, White Birch, Ash, Ironwood and Balsam Fir. Do not cut any other species. DO NOT cut Aspen larger than 18" dia or any hollow hardwood trees.

Utilization on all species is a 100" stick to a 4" top or whole tree. If harvesting whole tree, every 10th tree top above the 4" diameter must be left evenly scattered in the harvest area. Any den or nest trees shall be left uncut. Standing dead trees are not to be cut unless they pose a safety hazard.

2. Dry or frozen ground conditions will be required for harvesting and hauling activities. Access trails have numerous wet areas and the presence of numerous tag alder draws within the sale will likely require frozen ground. Year round operations may be permitted as long as rutting or road damage does not occur. Time restrictions may be imposed or the contract may be canceled if excessive rutting occurs in the woods or on the roads or if excessive damage to the residual trees occurs,

There are two stream crossings required to access the sale. **The contractor must give the county a minimum of 90 days notice of startup in order for stream crossing permits to be obtained. The type of crossing planned for each stream must be determined at the 90 day notice time.** The stream crossing on the east side of the sale is on a designated trout stream. Installation/removal of the crossing may NOT occur between Sep 15 and May 15.

3. Any new roads must have approval of the County prior to construction. Existing roads may be opened and improved and landing sites may be constructed with prior approval of the County. All trails must be returned to their original condition or better at the end of sale. Bond money will not be returned until all road/landing rehabilitation is complete.

There is a wetland crossing on the access road near S Turcott Rd. If any fill is placed on this crossing, it must only be placed within the existing footprint of the road. No fill shall be placed in wetlands outside the existing road footprint.

4. No equipment is allowed in the wetland areas within or adjacent to the sale unless the ground is frozen except that wetland crossings may be made using slash mats, poles or timber mats. Any material that originates from outside the wetland must be removed to the extent possible when use of the crossing is complete. No other slash is to be left in any wetlands within or adjacent to the sale. Equipment may not be operated within 15 feet of any wetland unless ground is dry or frozen.

No equipment is allowed across the Blue Paint Lines. Any trees felled across the Blue Paint Lines must be pulled back onto County property before limbing. Witness trees near the Survey Corner have been painted blue. Do not cut the blue painted trees or disturb the survey corner.

6. All items listed in the Oneida County Timber Sale Contract apply. All applicable BMP's will be followed. Sale Est. PF/JT 12/23

Oneida County Forest

BRGMA 2 Aspen

Compartment / Stand - 19/6, 26/14, and 27/15
 Sale Area: 69 ac
 (63 ac aspen coppice, 6 ac reserve)
 Legal Desc T35N R9E Sec. 6 SESW, NWSE, and S1/2 SE. Sec 7 NENE and W1/2 SW.

Approximate Sale Location

Tract # 06-24
 Town of Enterprise
 Contract No: _____
 Contractor: _____
 Date Sold: _____
 Date Completed: _____
 Contract Length: 3 years

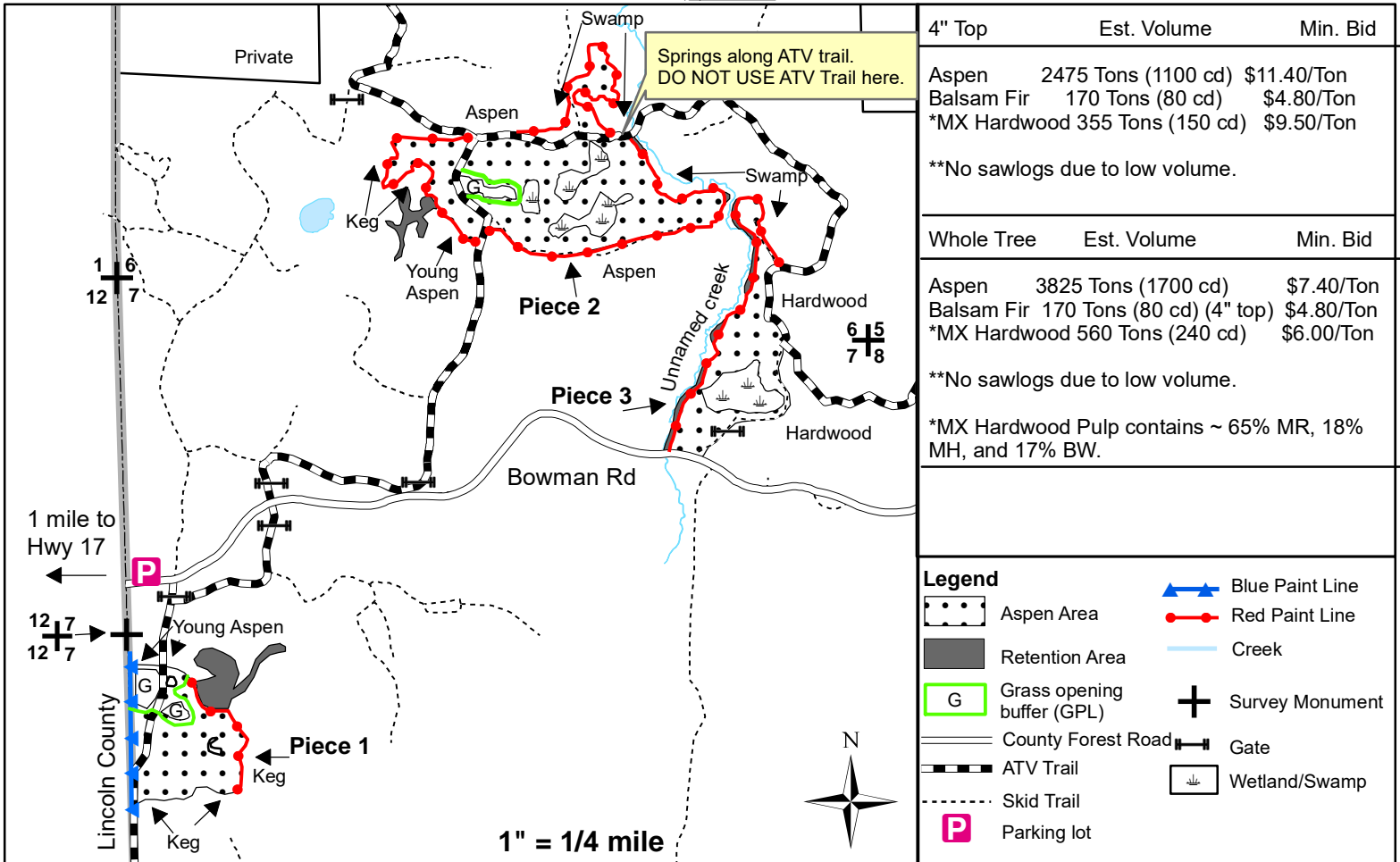

4" Top	Est. Volume	Min. Bid
Aspen	2475 Tons (1100 cd)	\$11.40/Ton
Balsam Fir	170 Tons (80 cd)	\$4.80/Ton
*MX Hardwood	355 Tons (150 cd)	\$9.50/Ton
**No sawlogs due to low volume.		

Whole Tree	Est. Volume	Min. Bid
Aspen	3825 Tons (1700 cd)	\$7.40/Ton
Balsam Fir	170 Tons (80 cd) (4" top)	\$4.80/Ton
*MX Hardwood	560 Tons (240 cd)	\$6.00/Ton
**No sawlogs due to low volume.		
*MX Hardwood Pulp contains ~ 65% MR, 18% MH, and 17% BW.		

Legend	
	Aspen Area
	Retention Area
	Grass opening buffer (GPL)
	County Forest Road
	ATV Trail
	Skid Trail
	Parking lot
	Blue Paint Line
	Red Paint Line
	Creek
	Survey Monument
	Gate
	Wetland/Swamp

Additional Regulations:

- In the aspen area, cut all aspen, maples, white birch, ash, basswood, balsam fir, elm, ironwood and musclewood 1" diameter or larger. Do not cut any other species. Do not cut aspen within 50' of the grass openings outlined in green paint, all other harvestable species may be cut. Slash must be evenly distributed across sale area (no large piles). Utilization on all species is a 100" stick to a 4" top or whole tree. If harvesting whole tree, every 10th tree top above the 4" diameter must be left evenly scattered in the harvest area. Any den or nest trees shall be left uncut. Standing dead trees are not to be cut unless they pose a safety hazard.
- Dry or frozen ground conditions are required for harvesting and hauling activities. Year round logging operations may be permitted as long as rutting or road damage does not occur. Further seasonal restrictions may be imposed if excessive rutting occurs in the woods or on the roads.
- No new roads are permitted. Existing roads may be opened and improved and landing sites may be constructed with prior approval of the County. Access roads connecting to the ATV trail must be blocked with berms/rocks or gates at the end of each harvest season and at the end of the sale. All trails and roads must be returned to their original condition or better at the end of each harvest season and at the end of the sale. Bond money will not be returned until all road/landing rehabilitation is satisfactorily complete. Debris must be removed from the ATV trail daily.
- No equipment is allowed in the wetland areas within or adjacent to the sale unless the ground is dry or frozen. No slash is to be left in any wetlands within or adjacent to the sale. Equipment may not be operated within 15 feet of any wetland unless the ground is dry or frozen.
- Slash must be pulled back 10' off the edge of the ATV trail and cut to lay less than 2' high within 25' of the trail and 25' off the edge of Bowman Rd and cut to lay less than 2' high within 50' of the road. Bowman Rd and the ATV trail must be repaired to the satisfaction of the County if either is used for skidding, decking, or hauling. Any trees felled across the property line (BPL) must be pulled back onto County property before being limbed. If the ATV trail is used for decking, decks must be placed far enough off the edge of the ATV trail so as not to pose a hazard to trail users and the trail kept clear of logging debris. Caution signs must be installed on the trail and Bowman Rd. Decking is allowed at the Bowman Rd parking lot as long as decks do not interfere with recreational parking and use.
- Each harvest area must be completely cut before moving onto another harvest area.
- All items listed in the Oneida County Timber Sale Contract apply. All applicable BMP's will be followed.

Sale Est. JF 11/23

Oneida County Forest

Black Powder Aspen

Tract # 07-24

Town of Woodboro

Contract No: _____

Contractor: _____

Date Sold: _____

Date Completed: _____

Contract Length: 3 years

Compartment / Stand - 38/10

Sale Area: 50 ac

(48 ac aspen coppice, 2 ac reserve)

Legal Desc T36N R7E Sec 10 SESW and SWSE.

Sec. 15 NENW and NWNE.

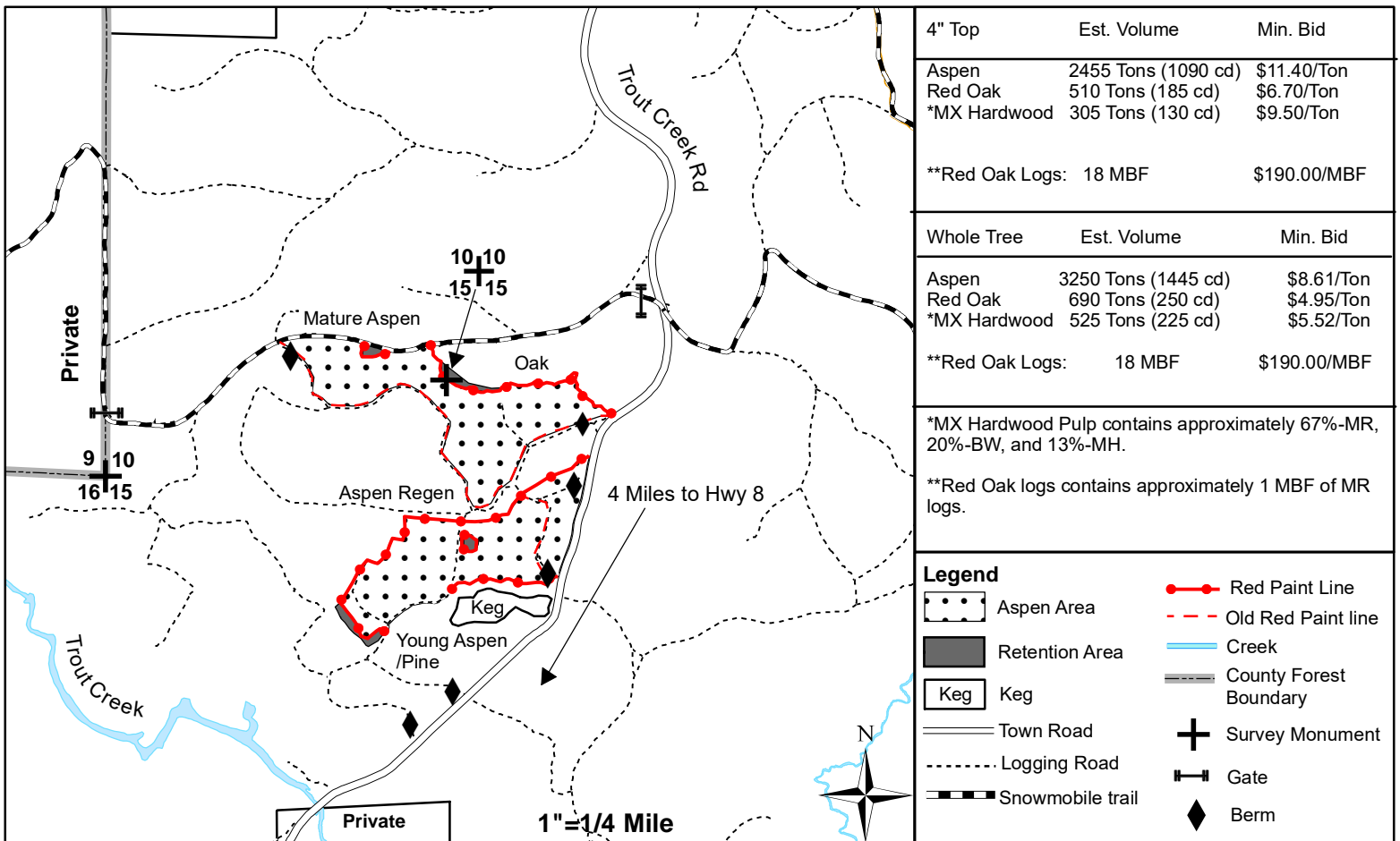

4" Top	Est. Volume	Min. Bid
Aspen	2455 Tons (1090 cd)	\$11.40/Ton
Red Oak	510 Tons (185 cd)	\$6.70/Ton
*MX Hardwood	305 Tons (130 cd)	\$9.50/Ton
**Red Oak Logs:	18 MBF	\$190.00/MBF

Whole Tree	Est. Volume	Min. Bid
Aspen	3250 Tons (1445 cd)	\$8.61/Ton
Red Oak	690 Tons (250 cd)	\$4.95/Ton
*MX Hardwood	525 Tons (225 cd)	\$5.52/Ton
**Red Oak Logs:	18 MBF	\$190.00/MBF

*MX Hardwood Pulp contains approximately 67%-MR, 20%-BW, and 13%-MH.

**Red Oak logs contains approximately 1 MBF of MR logs.

Legend

- Aspen Area
- Red Paint Line
- Retention Area
- Old Red Paint line
- Keg
- Creek
- County Forest Boundary
- Town Road
- Survey Monument
- Logging Road
- Gate
- Snowmobile trail
- Berm

Additional Regulations:

- In the aspen area, cut all aspen, maples, white birch, ash, basswood, cherry, elm, ironwood, and merchantable unmarked oak. Do not cut oak marked with green paint or any other species. Balsam fir may be cut and scattered. Trees with old red paint on them may be harvested. Slash must be evenly distributed across sale area (no large piles). Utilization on all species is a 100" stick to a 4" top or whole tree. If harvesting whole tree, every 10th tree top above the 4" diameter must be left evenly scattered in the harvest area. Any den or nest trees shall be left uncut. Standing dead trees are not to be cut unless they pose a safety hazard.
- Harvesting is only allowed from July 15th through April 15th of the following year to comply with oak wilt restrictions. Dry or frozen ground conditions are required for harvesting and hauling activities. Further seasonal restrictions may be imposed if excessive rutting occurs in the woods or on the roads or if excessive damage to the residual trees occurs.
- No new roads permitted. Existing roads may be opened and improved and landing sites may be constructed with prior approval of the County. Access roads and trails must be bermed/rocked or gated at the end of each harvest season and at the end of the sale. All trails and roads must be returned to their original condition or better at the end of each harvest season and at the end of the sale. Bond money will not be returned until all road/landing rehabilitation is complete to the satisfaction of the County. The snowmobile trail may be used by harvesting equipment, but may not be used for hauling during snowmobile season due to the numerous existing logging roads within the sale area. This section of Trout Creek Rd is not plowed by the town during winter. It is the contractors responsibility to open the road or arrange plowing with the town if hauling operations occur during winter.
- No equipment is allowed in the wetland areas within or adjacent to the sale unless the ground is dry or frozen. Do not operate equipment within 15' of any wetland unless the ground is dry or frozen. No slash is to be left in any wetlands within or adjacent to the sale.
- Signs will be needed on Trout Creek Rd and the snowmobile trail (if harvesting during snowmobile season) to notify users of logging operations. Slash must be pulled back 10' from the snowmobile trail and cut to lay less than 2' high within 25' of the trail and pulled back 25' off the edge of Trout Creek Rd and cut to lay less than 2' high within 50' of the road.
- If the snowmobile trail is used for harvesting operations, the trail must remain snow covered to the extent possible if used during snowmobile season. Gates are to remain closed during non-snowmobile season and when no one is on site. The trail must be bladed completely smooth at the end of each harvest season and the end of the sale.
- Do not disturb the survey monument or blue painted bearing trees located on the northern edge of the sale.
- All items listed in the Oneida County Timber Sale Contract apply. All applicable BMP's will be followed.

Sale Est. JF 12/23

Oneida County Forest McCoy Hardwood

Compartment / Stand - 81 / 2, 70 / 12
Sale Area: 98 total acres

Legal Description:
T37N R5E, W 1/2 NW, SESW Sec 31
T37N R4E, S 1/2 SE Sec 35
T37N R4E, E 1/2 NE, SWSW Sec 36
T36N R4E, NENW & N 1/2 NE Sec 2, N 1/2 NW Sec 1



Tract # 8-24
Town of Lynne
Contract Number: _____
Contractor: _____
Date Sold: _____
Date Completed: _____
Contract Length: 3 years

Total Advertised Sale Volume

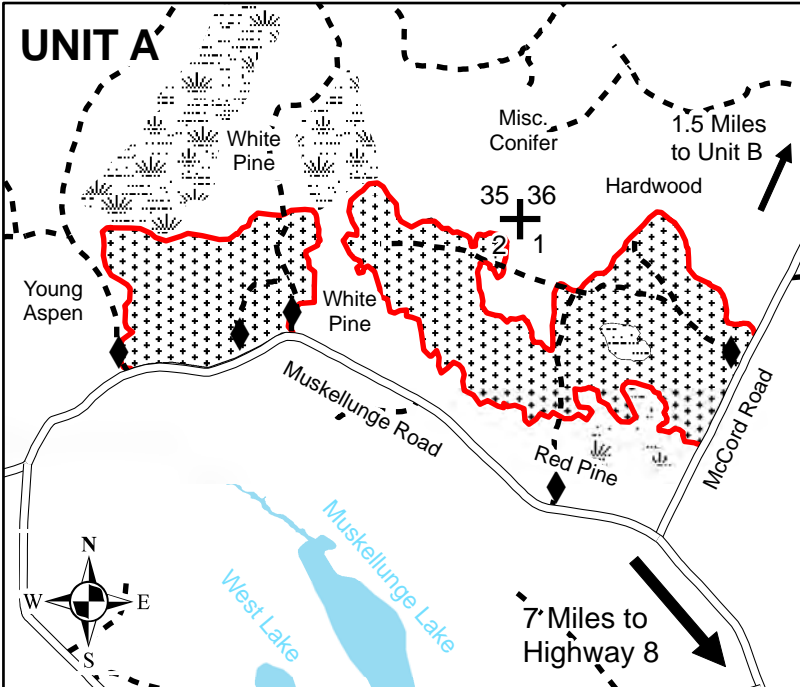

4" Top		
Pulpwood	Est. Volume	Min. Bid
¹ MX Hardwood	1550 tons (650 cds)	\$9.00/ton
² Red Pine	15 tons (7 cds)	\$18.00/ton
³ White Pine	150 tons (70 cds)	\$10.80/ton
⁴ Spruce	110 tons (55 cds)	\$9.00/ton
Aspen	270 tons (120 cds)	\$10.80/ton

¹Mixed hardwood pulp includes 56% hard maple, 30% soft maple, 14% paper birch, and <1% basswood.
²Red pine pulp includes 1.250 MBF.
³White pine pulp includes 2.000 MBF.
⁴Spruce pulp includes 82% white spruce and 18% balsam fir.

Sawlogs	Est. Volume	Min. Bid
⁵ MX Hardwood	9 MBF	\$150.00/MBF

⁵Mixed hardwood sawlogs include 76% soft maple, 15% hard maple, and 9% basswood.

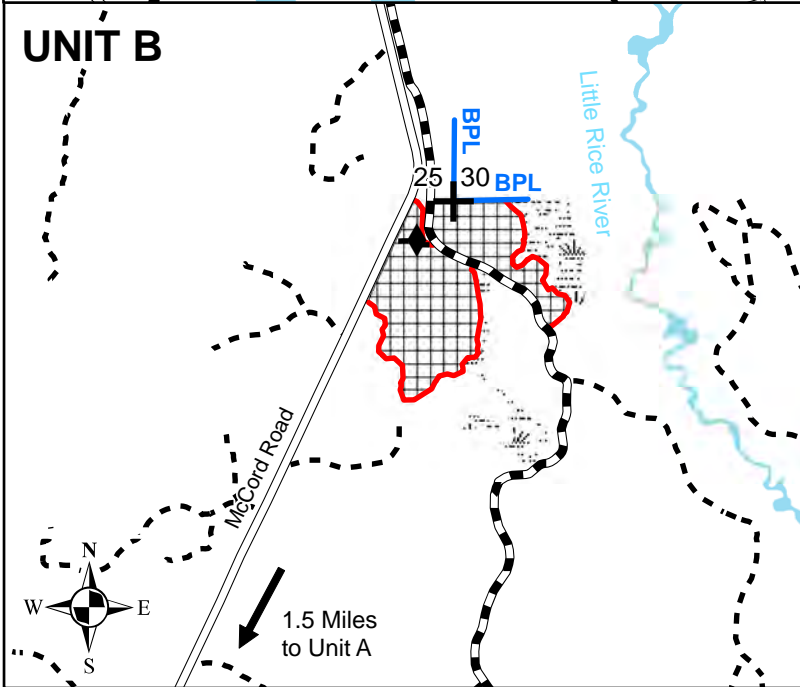

Legend	
	Unit A (Hardwood)
	Unit B (Birch Shelterwood)
	Wetland Area
	Water
	Red Painted Line (RPL)
	Blue Painted Line (BPL)
	Berm/Rocks
	Town Road
	Snowmobile/ATV Trail
	Woods Road
	Survey Corner

1 inch = 1/4 mile

Oneida County Forest McCoy Hardwood

Compartment / Stand - 81 / 2, 70 / 12

Sale Area: 98 total acres

Legal Description:

T37N R5E, W 1/2 NW, SESW Sec 31

T37N R4E, S 1/2 SE Sec 35

T37N R4E, E 1/2 NE, SWSW Sec 36

T36N R4E, NENW & N 1/2 NE Sec 2, N 1/2 NW Sec 1



Tract # 8-24

Town of Lynne

Contract Number: _____

Contractor: _____

Date Sold: _____

Date Completed: _____

Contract Length: 3 years

1. In Unit A, harvest all orange-marked trees, all ironwood 1" and greater, merchantable balsam of at least one stick or more to a 4" top, spruce 6-14", and pine 0-14" diameter. EXTREME CAUTION must be used to protect existing hardwood regeneration. Excessive damage to regen may result in further equipment restriction (such as no hot saws or fixed head harvester only) or contract cancellation.
2. In Unit B, harvest all white birch, aspen, ash, maples, and basswood. Do NOT cut spruce, oak, yellow birch, pine, hemlock, cedar, or balsam. DO NOT cut green marked trees. EXTREME CAUTION must be used to protect existing paper birch regeneration; NO HOT SAWS ALLOWED IN THIS AREA.
3. Utilization is 100" stick to a 4" top. NO WHOLE TREE OR POLE LENGTH SKIDDING.
4. Slash must be pulled back a minimum of 25 feet from Muskellunge and McCord Roads and must not exceed 2 feet in height within 50 feet of these roads; slash must be pulled back a minimum of 10 feet from snowmobile/ATV trail and less than 2 feet in height within 25 feet of the snowmobile/ATV trail. No other slash treatment is required. Any trees felled across the property line (BPL) must be pulled back onto County property before being limbed. Skidding or decking on Muskellunge or McCord Roads is permitted only with permission of the Town of Lynne. All damage to roads must be repaired immediately to the satisfaction of the Town. If decking occurs on the town roads, decks must be far enough off the road to prevent safety issues. All bark and debris must be removed from the road daily.
5. Existing woods roads may be improved and landings and turn-arounds constructed with prior approval of the County. No new roads may be constructed. All roads must be levelled and blocked with rocks, earth berm, or gate at the end of each harvesting season and at the end of the sale. If skidding or decking occurs on town roads, caution signs must be placed. Caution signs shall be placed on Muskellunge and McCord Roads when hauling is active.
6. No equipment is allowed to operate within 15 feet of any wetland or ephemeral pond within or adjacent to the sale unless the ground is very dry or frozen. No slash is to be left in any wetland or ephemeral pond. Harvesting and skidding is limited to July 15 through the following spring break-up (approximately March 15). Further seasonal restrictions may be imposed if excessive rutting occurs in the woods or on roads or if excessive damage to residual stems occurs.
7. All standing dead trees or den/nest trees must be left standing unless they pose a safety hazard to harvesting operations.
8. All items listed in the Oneida County Timber Sale Contract apply. All applicable BMPs will be enforced.

Oneida County Forest Two Rivers Aspen

Compartment / Stand - 12 / 1
 Sale Area: 89 total acres
 (85 acres cut, 4 acres GTR)
 Legal Description: T35N R9E
 S ½ NW, SWSW, NWSE, N ½ SW, SWSW Section 16
 NESE, SESE Section 17



Tract # 9-24
 Town of Enterprise
 Contract Number: _____
 Contractor: _____
 Date Sold: _____
 Date Completed: _____
 Contract Length: 3 years

Total Advertised Sale Volume

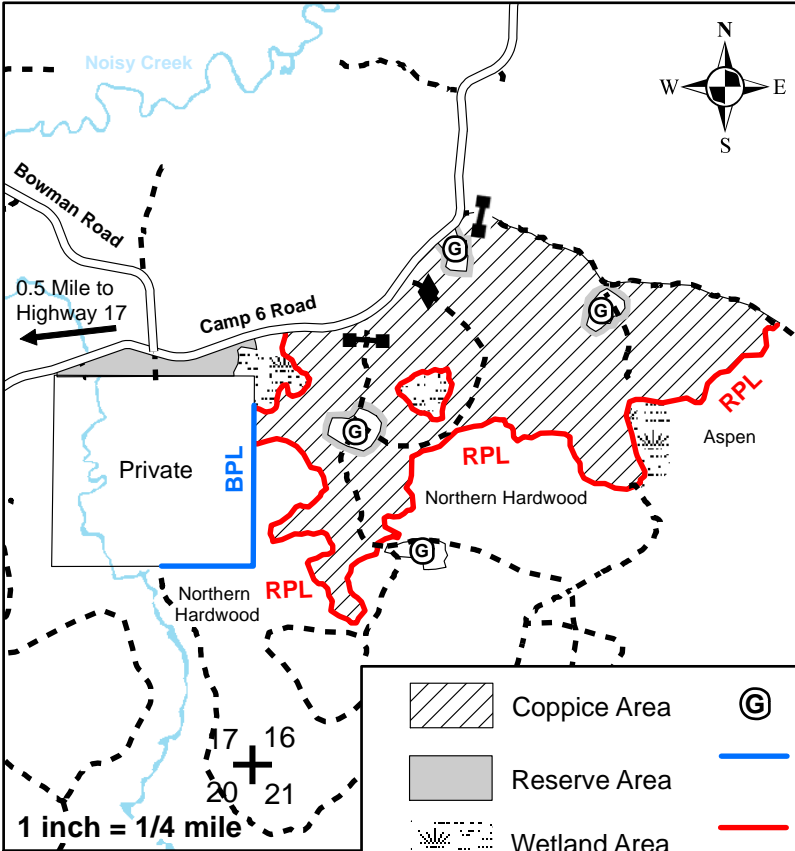

4" Top		
Pulpwood	Est. Volume	Min. Bid
Aspen	3900 tons (1750 cds)	\$12.00/ton
¹ MX Hardwood	440 tons (180 cds)	\$10.00/ton
Fir	20 tons (10 cds)	\$5.00/ton
¹ Mixed hardwood pulp includes 36% soft maple, 30% hard maple, 19% basswood, 9% ironwood + black cherry, and 6% paper birch.		
Whole Tree		
Pulp + Topwood	Est. Volume	Min. Bid
Aspen	5900 tons (2600 cds)	\$7.93/ton
² MX Hardwood	700 tons (360 cds)	\$6.29/ton
Fir	20 tons (10 cds)	\$5.00/ton
² Mixed hardwood whole tree includes 41% soft maple, 31% hard maple, 18% basswood, 6% ironwood + black cherry, and 4% paper birch.		

Legend

Coppice Area	Grass Opening	Gate	County Forest Road
Reserve Area	Blue Painted Line (BPL)	Berm	Woods Road
Wetland Area	Red Painted Line (RPL)	Survey Corner	

- In the harvest area, all aspen, ash, basswood, maple, ironwood, black cherry, balsam fir, and paper birch 1" diameter or larger shall be cut. Do not cut any other species. Do not cut any aspen within 50 feet of the grass opening. Year-round harvesting is allowed with dry or frozen ground.
- Utilization is 100" stick to a 4" top or whole tree. If harvesting whole tree, every 10th top above the standard 4" top shall be left evenly scattered throughout the sale area.
- Slash is to be pulled back from the edge of the gravel portion of county forest roads a minimum of 25 feet and cut to no higher than 2 feet from the ground throughout the sale. Skidding or decking on Camp 6 Road is permitted only with permission of the County. All damage to roads must be repaired immediately to the satisfaction of the County. If decking occurs on the county forest roads, decks must be far enough off the road to prevent safety issues. All bark and debris must be removed from the road daily. Any trees felled across the property line (BPL) must be pulled back onto County property before being limbed.
- The grass openings may be used for a landing, however, if any topsoil is scraped off it must be evenly spread across disturbed areas and graded smooth to facilitate mowing post-sale. All bark and slash must be completely removed from the grass openings, not pushed in piles along the edge. Existing roads may be improved and landings and turn-arounds constructed with prior approval of the County. All roads must be leveled and blocked with rocks, earth berm, or gate at the end of each harvesting season and at the end of the sale. If skidding or decking occurs on county forest roads, caution signs must be placed. If hauling activities take place during snowmobile or ATV season, caution signs shall be placed on Camp 6 Road. Camp 6 Road is a snowmobile trail and must remain snow-covered to the extent possible.
- No equipment is allowed to operate within 15 feet of any wetland or ephemeral pond within or adjacent to the sale unless the ground is very dry or frozen. No slash is to be left in any wetland or ephemeral pond.
- All standing dead trees or den/nest trees must be left standing unless they pose a safety hazard to harvesting operations.
- All items listed in the Oneida County Timber Sale Contract apply. All applicable BMPs will be enforced. Sale Est. 3/24 KW/DNR

Oneida County Forest

Pocket Pine

Compartment / Stand 107/9,10; 108/19
 Harvest Area: 76 Ac (74 thinning, 2 clearcut)
 Legal Desc. T35N R9E
 Sec. 13 S1/2SW
 Sec. 14 E1/2SE, NWSE
 Sec. 23 NENE
 Sec. 24 NWNW



Tract # 10-24
 Town of Lynne
 Contract No.: _____
 Contractor: _____
 Date Sold: _____
 Date Completed: _____
 Contract Length: **2 Years**

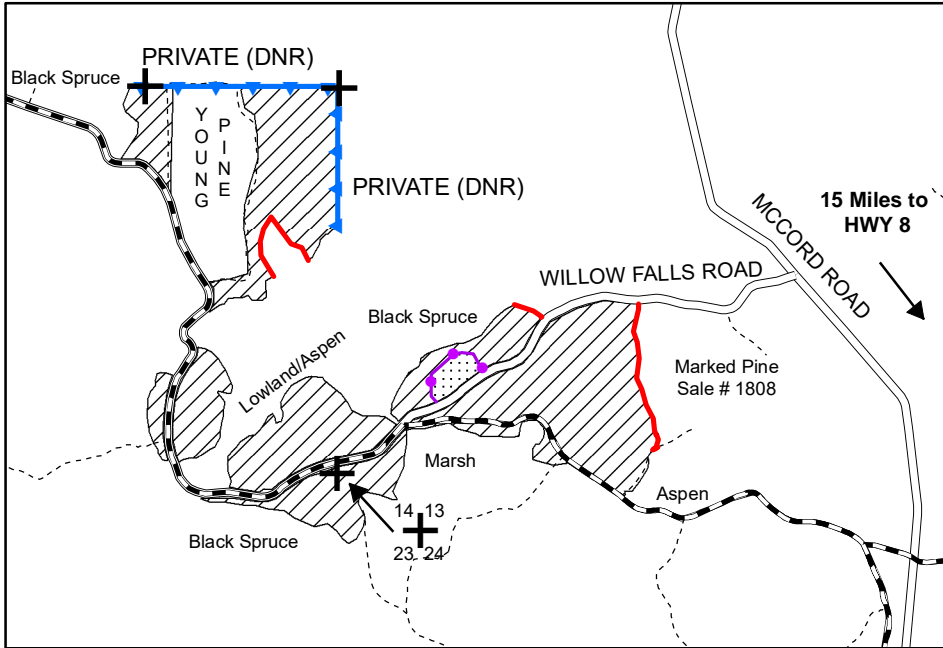

4" Top	Est. Volume	Min. Bid
Red Pine	2200 Tons (978 cd)	\$20.00/Ton

Note: Heterobasidion (Annosum) Root Disease preventative spraying requirements will be implemented if HRD is found in Oneida County or an adjacent county prior to or during the period of this contract. See Timber Sale Contract for details.

	Thinning		Town Road
	Clearcut		Woods Road
	Purple Paint Line		Survey Corner
	Red Paint Line		ATV/Snowmobile Trail
	Blue Paint Line		



1 inch = 1/4 mile

Clearcut must be harvested within 1st year of the contract.

Additional Regulations:

- In the Thinning Area (74 ac) cut all pine marked with orange paint. (Average diameter of pine is 12")
 In the Clearcut Area (2 ac) cut ALL red pine within the purple paint line. Clearcut Area must be cut within 1st year of the contract. Utilization on all species is a 100" stick to a 4" top. Any den or nest trees shall be left uncut. Cut all standing dead trees. Contractor shall notify County of any other areas of decline.
- Year-round harvesting is permitted when ground is dry or frozen. Time restrictions may be imposed if rutting occurs in the woods or on the roads or if excessive damage to the residual trees occurs.
- No new roads will be permitted. Existing roads may be opened and improved and landing sites may be constructed with prior approval of the County. The main access is via Willow Falls Road and an ATV/Snowmobile trail. This trail must be kept open and in a safe useable condition during both ATV and Snowmobile seasons. All trails will be returned to their original condition or better at the end of sale. Trails must be kept clear of debris on a daily basis. If cut during winter season, snowmobile trail must remain snow covered during snowmobile season. Bond money will not be returned until all road/landing rehabilitation is complete. No skidding or decking on Willow Falls Rd unless permission is granted by the Town of Lynne.
- All pine products cut between May 1 and September 1 must be removed from the sale area within 2 weeks from the time of harvest. Pine products cut during the remainder of the year must be removed prior to May 1 of each year. No whole tree skidding allowed, maximum of 17' pole length, utility poles dealt with on case by case basis.
- No equipment or slash is allowed in the wetland areas within or adjacent to the sale. Equipment may not be operated within 15 feet of any wetland unless ground is dry or frozen. No equipment to be operated across Blue Paint Line. Any tree felled across B.P.L. must be pulled back and limbed on Oneida County property.
- Slash must be pulled back a minimum of 25 ft from the edge of the Town Road and the ATV/snowmobile trail and must be cut to no higher than 2 ft off the ground within 50 ft of the road and trail. If operations occur during ATV/snowmobile season, cautionary signs must be placed at both ends of the trail and along the Town Road.
- All items listed in the Oneida County Timber Sale Contract apply. All applicable BMP's will be followed. Sale Est. OCFD/DNR 1/24

Oneida County Forest J-Hook Aspen

Compartment / Stand - 41 / 10, 42 / 15
 Sale Area: 67 total acres
 (64 acres cut, 3 acres GTR)
 Legal Description: T36N R06E
 S 1/2 NW, SW 1/4, SWSE Sec. 24
 NE 1/4, NENW Sec. 25



Tract # 11-24
 Town of Woodboro
 Contract Number: _____
 Contractor: _____
 Date Sold: _____
 Date Completed: _____
 Contract Length: 3 years

Total Advertised Sale Volume

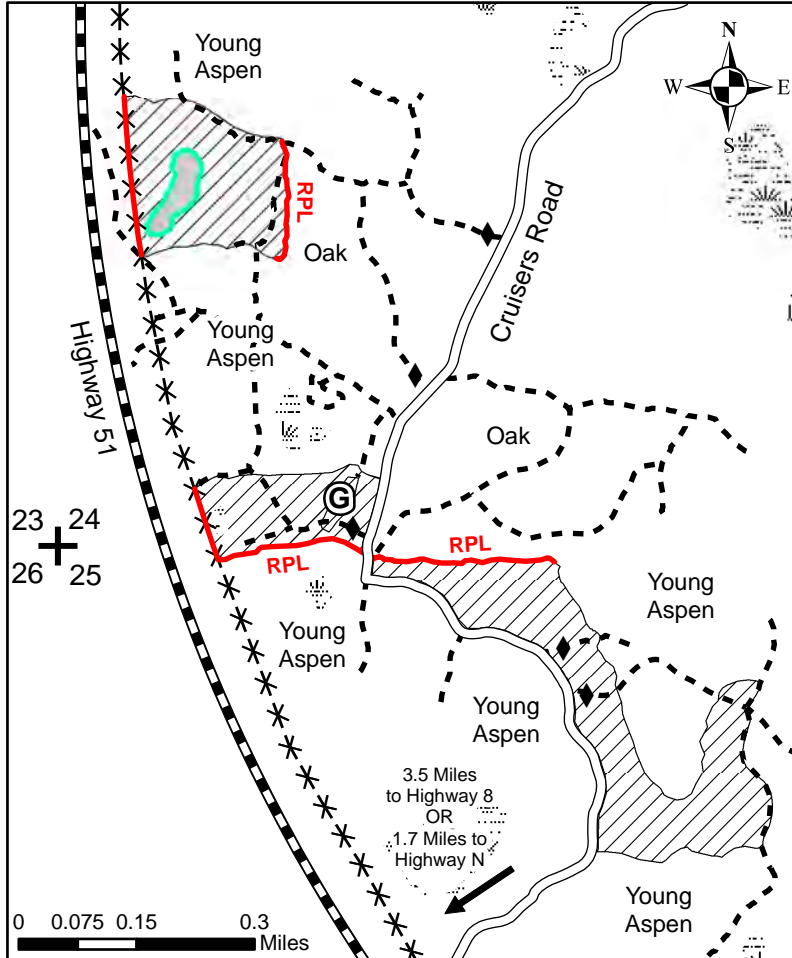

4" Top		
Pulpwood	Est. Volume	Min. Bid
Aspen	3650 tons (1600 cds)	\$12.00/ton
¹ MX Hardwood	930 tons (390 cds)	\$10.00/ton
¹ Mixed hardwood pulp includes 78% soft maple (1 MBF), 16% red oak, 4% hard maple and basswood (1 MBF), 1% ash and cherry.		
Sawlogs	Est. Volume	Min. Bid
Red Oak	5 MBF	\$200.00/MBF
Whole Tree		
Pulp + Topwood	Est. Volume	Min. Bid
Aspen	4680 tons (2080 cds)	\$9.36/ton
² MX Hardwood	1470 tons (612 cds)	\$6.32/ton
² Mixed hardwood whole tree volume includes 77% soft maple (1 MBF), 18% red oak, 2% hard maple, 1% basswood (1 MBF), 1% black cherry, and 1% ash.		
Sawlogs	Est. Volume	Min. Bid
Red Oak	5 MBF	\$200.00/MBF

Legend	
◆	Berm
▨	Harvest Area
■	Reserve Area
⊗	Wetland Area
Ⓞ	Grass Opening
—+—+—	State Highway
—	County Forest Road
- - -	Woods Road
—	Red Painted Line (RPL)
* * *	Highway 51 ROW Fence

- In the harvest area, harvest all orange-marked trees, aspen, maple, ash, basswood, and ironwood 1" diameter or larger. Do not cut any other species. Do not cut any aspen within 50 feet of the grass opening.
- Utilization is 100" stick to a 4" top or whole tree. If harvesting whole tree, every 10th top above the standard 4" top shall be left evenly scattered throughout the sale area.
- Dry or frozen ground conditions will be required for harvesting and hauling activities. Harvesting/skidding is limited to July 15 through the following March 15 (oak wilt restrictions). Further time restrictions may be imposed if excessive rutting occurs in the woods or on the roads or if excessive damage to the residual trees occurs. If grass openings are used for landings, they must be leveled and have topsoil spread evenly upon completion. All bark/logging debris must also be removed from the grass openings, not pushed in piles along the edge.
- Slash is to be pulled back from the edge of the gravel portion of Cruisers Road a minimum of 25 feet and cut to no higher than 2 feet from the ground throughout the sale. Skidding or decking on Cruisers Road is permitted only with permission of the County. All damage to roads must be repaired immediately to the satisfaction of the County. If decking occurs on Cruisers Road, decks must be far enough off the road to prevent safety issues. All bark and debris must be removed from the road daily.
- Existing roads may be improved and landings and turn-arounds constructed with prior approval of the County. All roads must be leveled and blocked with rocks, earth berm, or gate at the end of each harvesting season and at the end of the sale. If skidding or decking occurs on County Forest roads, caution signs must be placed at either end of the sale area. If hauling activities take place during ATV and snowmobile season, caution signs shall be placed on Cruisers Road. Roads must be kept snow covered to the extent possible when snowmobile trails are open.
- No equipment is allowed to operate within 15 feet of any wetland or ephemeral pond within or adjacent to the sale unless the ground is very dry or frozen. No slash is to be left in any wetland or ephemeral pond.
- All standing dead trees or den/nest trees must be left standing unless they pose a safety hazard to harvesting operations.
- All items listed in the Oneida County Timber Sale Contract apply. All applicable BMPs will be enforced.

Oneida County Forest Mystery Pine

Compartment / Stand - 72 / 3
 Sale Area: 21 total acres
 Legal Description: T36N R4E,
 W ½ SW Section 1



Tract #12-24
 Town of Lynne
 Contract Number: _____
 Contractor: _____
 Date Sold: _____
 Date Completed: _____
 Contract Length: 2 years

Total Advertised Sale Volume

4" Top

Pulpwood	Est. Volume	Min. Bid
Red Pine	400 tons (175 cds)	\$12.00/ton

Heterobasidion (Annosum) Root Disease (HRD) preventative spraying requirements will be implemented if HRD is found in Oneida County or an adjacent county prior to or during the period of this contract. See Timber Sale Contract for details.

PLEASE NOTE No portion of this sale area touches other lands of non-County ownership--no BPL has been established in the field. Operator **MUST** stay within the painted redline.

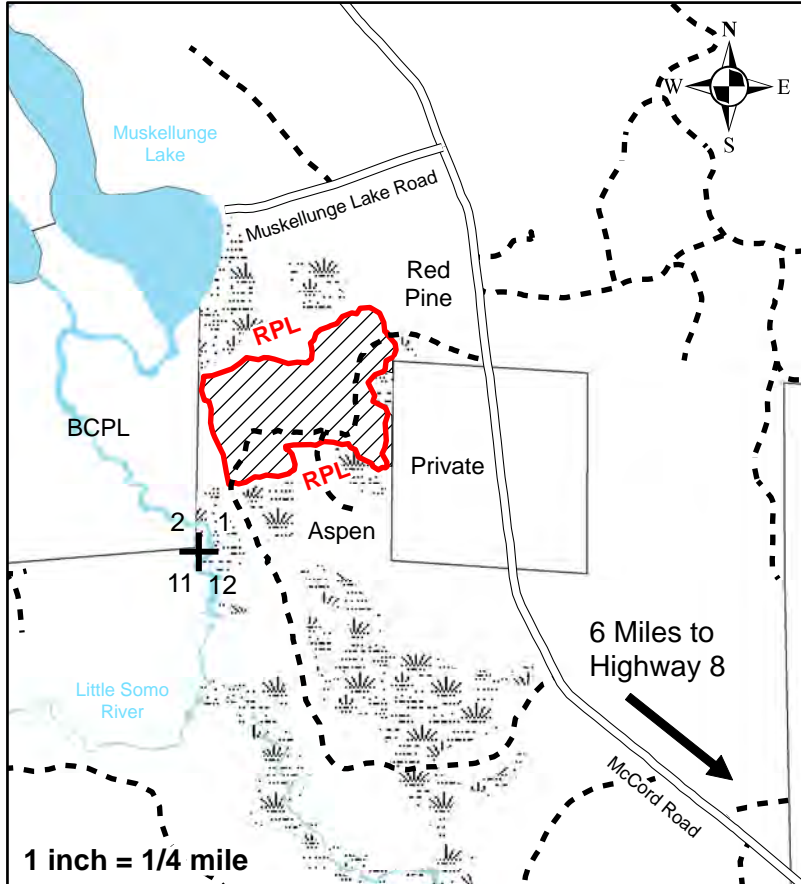

Legend

	Thinning Area		Town Road
	Wetland Area		Woods Road
	Red Painted Line (RPL)		Survey Corner
			Water

- In the Thinning Area, cut all pine marked with orange paint and all merchantable balsam fir. 2nd thinning, average diameter is 10". Utilization on all species is a 100" stick to a 4" top. No whole tree utilization is allowed. Any den or nest trees shall be left uncut. Standing dead trees are not to be cut unless they pose a safety hazard.
- All pine cut between May 1 and September 1 must be removed from the sale area within 2 weeks from the time of harvest. Pine products cut during the remainder of the year must be removed prior to May 1 of each year. No whole tree skidding is allowed, maximum of 17' pole length.
- Year-round harvesting is permitted when ground is dry or frozen. Time restrictions may be imposed if rutting occurs in the woods or on roads or if excessive damage to the residual trees occurs.
- Skidding or decking on McCord Road is permitted only with permission of the Town of Lynne. All damage to roads must be repaired immediately to the satisfaction of the Town. If decking occurs on the town roads, decks must be far enough off the road to prevent safety issues. All bark and debris must be removed from the road daily. If skidding or decking occurs on town roads, caution signs must be placed. If hauling activities take place during snowmobile or ATV season, caution signs shall be placed on McCord Road. All roads must be leveled at the end of each harvesting season and at the end of the sale.
- No equipment is allowed to operate within 15 feet of any wetland or ephemeral pond within or adjacent to the sale unless the ground is very dry or frozen. No slash is to be left in any wetland or ephemeral pond.
- All items listed in the Oneida County Timber Sale Contract apply. All applicable BMPs will be enforced.

Oneida County Forest Crop Circle Pine

Compartment / Stand – 112 / 3, 100 / 3
 Sale Area: 31 total acres
 Legal Description: T37N, R4E
 Section 4 W 1/2 NE
 Section 5 SENW, SWNE, SW 1/4, NWSE



Tract # 13-24
 Town of Lynne
 Contract Number: _____
 Contractor: _____
 Date Sold: _____
 Date Completed: _____
 Contract Length: 3 years

Heterobasidion (Annosum) Root Disease (HRD) preventative spraying requirements will be implemented if HRD is found in Oneida County or an adjacent county prior to or during the period of this contract. See Timber Sale Contract for details.

Total Advertised Sale Volume

4" Top		
Pulpwood	Est. Volume	Min. Bid
Red Pine	1530 tons (680 cds)	\$20.00/ton

1. In the Thinning Area, cut all pine marked with orange paint and all merchantable balsam fir. This is a third thinning harvest with an average diameter of 14". Utilization on all species is a 100" stick to a 4" top. No whole tree utilization is allowed. Any den or nest trees shall be left uncut. Standing dead trees shall be cut due to forest stand health concerns.
2. Unit A and B cutting restrictions:
 - **Unit A—No harvesting between May 1 and September 15**
 - **Unit B—No harvesting between March 15 and October 31**
3. All pine cut between May 1 and September 1 must be removed from the sale area within two weeks from the time of harvest. Pine products cut during the remainder of the year must be removed prior to May 1 of each year. No whole tree skidding is allowed, maximum of 17' pole length. Utility poles dealt with on a case-by-case basis.
4. Time restrictions may be imposed if rutting occurs in the woods or on roads or if excessive damage to the residual trees occurs.
5. Skidding or decking on Timms Road or Wilson Road is permitted only with permission of the Town of Lynne. All damage to roads must be repaired immediately to the satisfaction of the Town. If decking occurs on the town roads, decks must be far enough off the road to prevent safety issues. All bark and debris must be removed from the road daily. If skidding or decking occurs on town roads, caution signs must be placed. If hauling activities take place during snowmobile season, caution signs shall be placed on Timm and Wilson Road. All logging roads must be leveled and blocked with rocks, earth berm, or gate at the end of each harvesting season and at the end of the sale. Slash must be pulled back a minimum of 25 feet from Muskellunge and McCord Roads and must not exceed 2 feet in height within 50 feet of these roads; slash must be pulled back a minimum of 10 feet from snowmobile/ATV trail and less than 2 feet in height within 25 feet of the trail. Any trees felled across the property line (BPL) must be pulled back onto County property before being limbed.
6. No equipment is allowed to operate within 15 feet of any wetland or ephemeral pond within or adjacent to the sale unless the ground is very dry or frozen. No slash is to be left in any wetland or ephemeral pond.
7. All items listed in the Oneida County Timber Sale Contract apply. All applicable BMPs will be enforced.

Oneida County Forest

Price County Line Hardwoods III

Compartment / Stand 99/7
 Harvest Area 215 Ac
 Legal Desc. T37N R4E
 Sec 7: SW1/4, SWNW
 Sec 18: NW1/4

Tract # 14-24
 Town of Lynne
 Contract No.: _____
 Contractor: _____
 Date Sold: _____
 Date Completed: _____
 Contract Length: 4 years

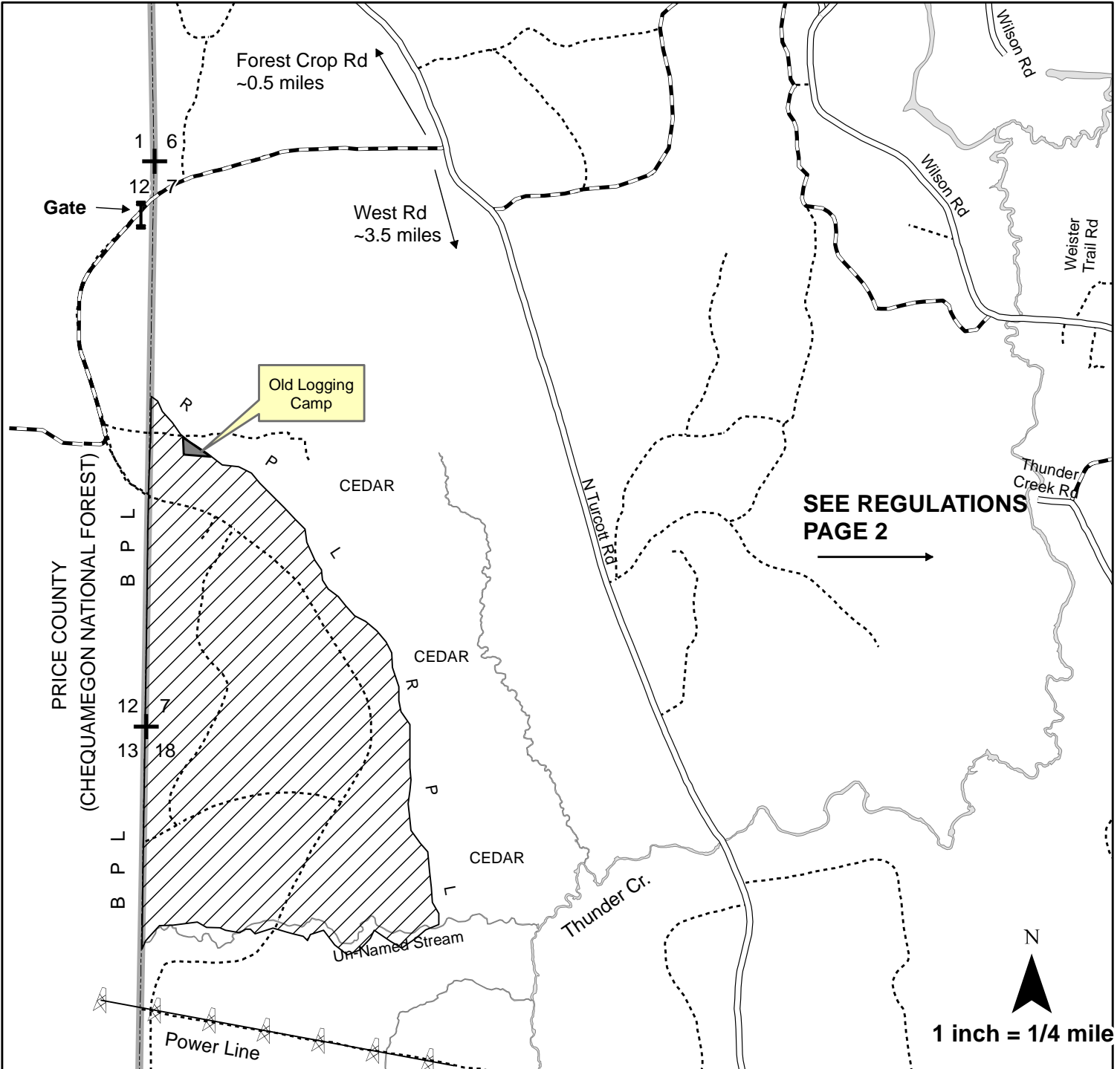

4" Top	Est. Volume	Min. Bid
*MX Hardwood	4950 Tons (2020 cd)	\$4.50/Ton
Basswood	650 Tons (337 cd)	\$1.40/Ton
Aspen	250 Tons (111 cd)	\$7.60/Ton
Balsam Fir	30 T (14 cd)	\$2.00/Ton
*Mx Hwd= 68% H Maple, 22% Red Maple, 9% Ash, 1% Birch		

Legend

- Marked Hardwood Area
- Logging Camp Retention Area
- Snowmobile Trail
- Town Road
- RPL Red Paint Line
- BPL Blue Paint Line
- Survey Corner

Oneida County Forest Price County Line Hardwoods III

Compartment / Stand 99/7
Harvest Area 215 Ac
Legal Desc. T37N R4E
Sec 7: SW1/4, SWNW
Sec 18: NW1/4



Tract # 14-24
Town of Lynne
Contract No.: _____
Contractor: _____
Date Sold: _____
Date Completed: _____
Contract Length: 4 years

SEE MAP PAGE 1



Additional Regulations:

1. **In the Marked Hardwood Area**, harvest all trees marked with orange paint along with all Balsam Fir and Ironwood 1" diameter or larger.
Canopy gaps have been established and are marked with purple paint. Cut all trees 1" diameter or larger within the purple painted areas along with the purple painted trees. Do not concentrate slash/tops in the gaps.
Utilization on all species is 100" stick to a 4" top. **Do NOT** harvest or damage any other trees. Do not fell trees into or skid through pockets of hardwood regeneration to the extent possible. If damage to the residual stand or regeneration is deemed excessive by the County, additional restrictions (fixed head harvester only) will be imposed or the contract may be cancelled.
2. Logging operations are restricted to the dates from July 15 through the following Spring Breakup and only when the ground is dry enough or frozen to prevent rutting. However, the access road from N. Turcott Rd passes through wetlands so frozen ground will likely be required.
3. No equipment will be allowed to operate within 15 feet of the stream on the south end of the sale. No slash is to be left in the creek. No equipment is to cross the rock ford across the creek unless the ground and creek are frozen.
4. Any trees felled across the blue line must be pulled back onto the sale area before limbing or bucking occurs.
5. Any trees felled into wetlands either within or adjacent to the sale must be pulled back onto high ground before limbing or bucking. No equipment is to operate in any wetland unless the ground is frozen or approved timber mats are used.
6. Access is limited to the existing road/trail system. No new roads will be allowed. Landing and turn-arounds must have approval of the County prior to construction. No landings, decking or skidding is allowed west of the blue line. The snowmobile trail must be kept open, snow covered and in a safe, useable condition at all times. Caution signs must be placed on the snowmobile trail. All trails must be levelled at the end of each harvest season and must be returned to their original condition or better at the end of the sale. Bond money will not be returned until all road/trail work is completed.
7. The gate on the snowmobile trail must be closed at the end of each day and during periods of inactivity except during snowmobile season. Caution signs must be placed on the snowmobile trail if used during snowmobile season.
8. Caution must be used when operating in the vicinity of the old logging camp. No trees are to be felled into and no skidding through the excluded area. Damage to the structure will not be tolerated.
9. All applicable BMPs must be followed on all aspects of the sale.
10. All items of the timber sale contract also apply. Original sale Est: 10/13 County/DNR.

4" Top	Est. Volume	Min. Bid
*MX Hardwood	4950 Tons (2020 cd)	\$4.50/Ton
Basswood	650 Tons (337 cd)	\$1.40/Ton
Aspen	250 Tons (111 cd)	\$7.60/Ton
Balsam Fir	30 T (14 cd)	\$2.00/Ton
*Mx Hwd= 68% H Maple, 22% Red Maple, 9% Ash, 1% Birch		

Legend			
	Marked Hardwood Area	RPL	Red Paint Line
	Retention Area	BPL	Blue Paint Line
	Snowmobile Trail		Survey Corner
	Town Road		

Oneida County Forest Ironsides Hardwood

Compartment / Stand - 6 / 7, 18
 Sale Area: 110 total acres
 Legal Description: T35N R9E,
 N ½ Section 2



Tract # 7-23
 Town of Enterprise
 Contract Number: _____
 Contractor: _____
 Date Sold: _____
 Date Completed: _____
 Contract Length: 3 years

Total Advertised Sale Volume

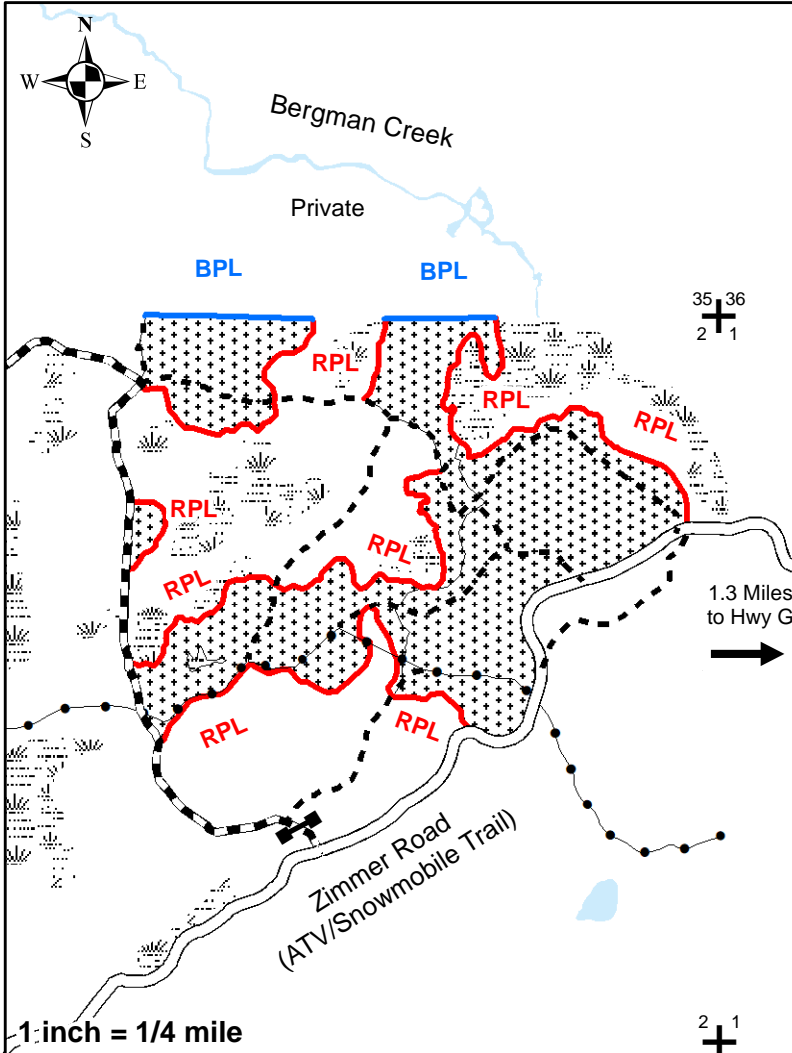

4" Top		
Pulpwood	Est. Volume	Min. Bid
¹ MX Hardwood	1010 tons (425 cords)	\$8.90/ton
Fir	30 tons (15 cords)	\$4.50/ton
¹ Mixed hardwood pulp includes 44% soft maple, 37% hard maple, 7% ash, 6% birch, 5% basswood, and 1% aspen.		
Sawlogs	Est. Volume	Min. Bid
² MX Hardwood	27 MBF	\$135.00/MBF
Basswood	25 MBF	\$113.00/MBF
² Mixed hardwood sawlogs include 35% soft maple, 30% hard maple, 27% paper birch, and 4% each yellow birch and red oak.		
Whole Tree		
Pulp	Est. Volume	Min. Bid
³ MX Hardwood	1330 tons (570 cords)	\$6.76/ton
Fir	30 tons (15 cords)	\$4.50/ton
Sawlogs	Est. Volume	Min. Bid
² MX Hardwood	27 MBF	\$135.00/MBF
Basswood	25 MBF	\$113.00/MBF

<table border="0"> <tr> <td></td> <td>Marked Area</td> </tr> <tr> <td></td> <td>Wetland Area</td> </tr> <tr> <td></td> <td>Red Painted Line (RPL)</td> </tr> <tr> <td></td> <td>Blue Painted Line (BPL)</td> </tr> <tr> <td></td> <td>Woods Road</td> </tr> </table>		Marked Area		Wetland Area		Red Painted Line (RPL)		Blue Painted Line (BPL)		Woods Road	<table border="0"> <tr> <td></td> <td>ATV/Snowmobile Trail</td> </tr> <tr> <td></td> <td>Bike/Ski/Snowshoe Trail</td> </tr> <tr> <td></td> <td>Survey Corner</td> </tr> <tr> <td></td> <td>County Forest Road</td> </tr> <tr> <td></td> <td>Water</td> </tr> <tr> <td></td> <td>Gate</td> </tr> </table>		ATV/Snowmobile Trail		Bike/Ski/Snowshoe Trail		Survey Corner		County Forest Road		Water		Gate
	Marked Area																						
	Wetland Area																						
	Red Painted Line (RPL)																						
	Blue Painted Line (BPL)																						
	Woods Road																						
	ATV/Snowmobile Trail																						
	Bike/Ski/Snowshoe Trail																						
	Survey Corner																						
	County Forest Road																						
	Water																						
	Gate																						

Legend

1. In the marked hardwood area, harvest all balsam fir and ironwood 1" or larger and all orange-marked trees, leaving orange visible on the stump. Do not cut aspen unless orange marked. EXTREME CAUTION must be used to protect existing hardwood regeneration. Excessive damage to regen may result in further equipment restrictions (such as no hot saws or fixed head harvesters only), or contract cancellation. Slash must be evenly distributed across the sale area (no large piles). NO WHOLE TREE OR POLE LENGTH SKIDDING. Slash should not be concentrated in canopy gap areas. Utilization on all species is a 100" stick to a 4" top or whole tree. Any den or nest trees shall be left uncut. Standing dead trees are not to be cut unless they pose a safety hazard.
2. Dry or frozen ground conditions will be required for harvesting and hauling activities. Harvesting/skidding in the harvest area is limited to July 15 through the following spring break-up (approximately March 15). Further seasonal restrictions may be imposed if excessive rutting occurs in the woods, the roads, or if excessive damage to residual trees occurs.
3. No new roads are permitted. Existing roads may be opened and improved, and landing sites may be constructed with prior approval of the County. Access roads connecting to Zimmer Road or the ATV trail must be blocked with berms, rocks, or a gate at the end of each harvest season and at the end of the sale. All trails must be returned to their original condition or better at the end of sale operations. Bond money will not be returned until all road/landing rehabilitation is satisfactorily complete. Debris must be removed from the ATV/snowmobile trail daily. Snowmobile trail must remain snow covered during the snowmobile season. Bike/snowshoe trail must be clear of all debris at the end of each day if harvesting during ski season. The trail must be returned to its original condition or better at the end of each harvest season and at completion of the sale.
4. No equipment is allowed in the wetland or lowland areas within or adjacent to the sale unless the ground is frozen. No slash is to be left in any wetlands within or adjacent to the sale. Equipment may not be operated within 15 feet of any wetland or lowland unless ground is dry or frozen.
5. Slash must be pulled back to 10 feet from the edge of the ATV/snowmobile trail and cut to less than 2 feet high within 25 feet of the trail. Slash along Zimmer Road must be cut to less than 2 feet high within 50 feet of the road. Zimmer Road and the ATV trail must be repaired to the satisfaction of the County if either is used for skidding, decking, or hauling.
6. If the ATV/snowmobile trail is used for skidding, caution signs must be installed on the trail. The trail shall be restored to as good or better condition once the sale is complete and be kept in good condition on a daily basis. If decking occurs on the ATV trail or Zimmer Road, decks must be placed far enough from the edge of the road so as not to pose a hazard to trail users.
7. All items listed in the Oneida County Timber Sale Contract apply. All applicable BMPs will be followed.

Oneida County Forest South Shore Hardwood

Compartment / Stand - 26/8 and 25/27
 Sale Area: 54 Acre Hardwood thinning and
 10 Acre RMZ
 Legal Desc. T35N R9E Sec. 19 S1/2 NW,
 NESW



Tract # 18-23
 Town of Enterprise
 Contract No.: _____
 Contractor: _____
 Date Sold: _____
 Date Completed: _____
 Contract Length: 3 years

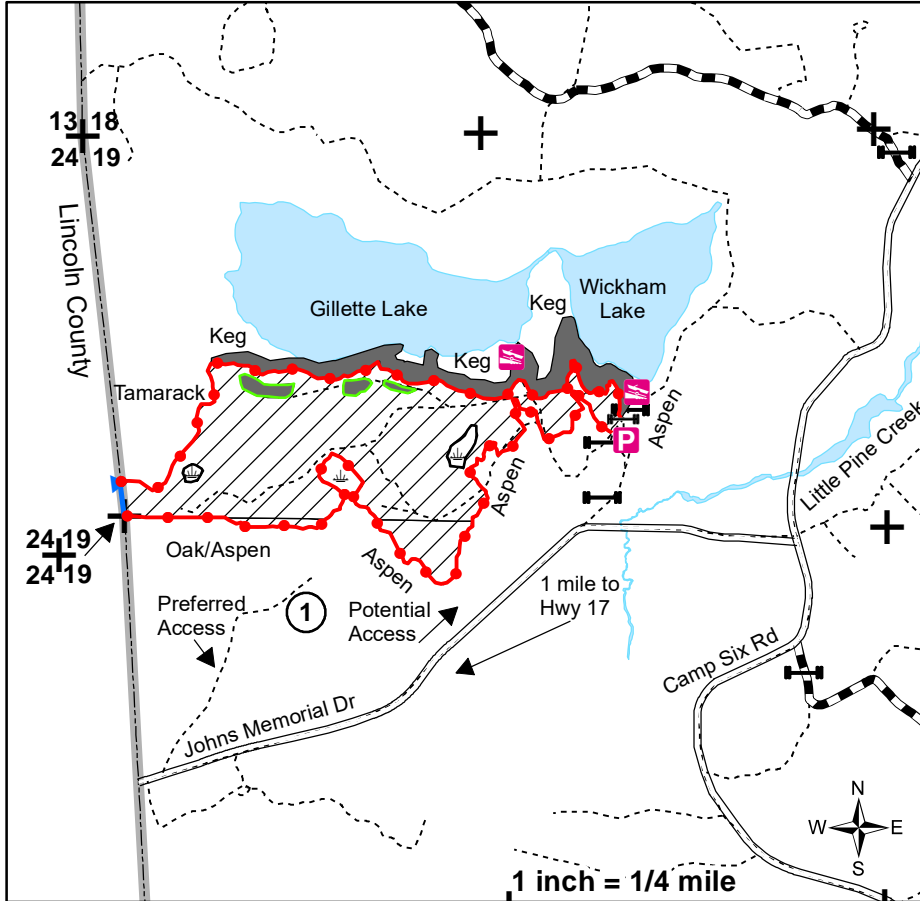

4" Top	Est. Volume	Min. Bid
*Mx Hardwood	520 Tons (210 cd)	\$8.70/Ton
Basswood	185 Tons (95 cd)	\$2.60/Ton
Aspen	115 Tons (50 cd)	\$11.60/Ton
Balsam Fir	65 Tons (30 cd)	\$4.90/Ton
**Mx Hwd Logs:	6 MBF	\$146.00/MBF
Basswood Logs:	28MBF	\$121.00/MBF

Whole Tree	Est. Volume	Min. Bid
*Mx Hardwood	860 Tons (350 cd)	\$5.26/Ton
Basswood	235 Tons (120 cd)	\$2.05/Ton
Aspen	145 Tons (65 cd)	\$9.20/Ton
Balsam Fir	65 Tons (30 cd)	\$4.90/Ton
**Mx Hwd Logs:	6 MBF	\$146.00/MBF
Basswood Logs:	28 MBF	\$121.00/MBF

*MX Hardwood Pulp contains approximately 62% MH, 18% BW, 12% Ash, and 8% MR.
 **Mx Hardwood Logs contains approximately 50% BW, 20% MH, 20% OR, and 10% Ash

Legend

- Marked Hardwood Area
- Blue Paint Line (BPL)
- Waterbody
- Town Road
- Young Aspen
- ATV Trail
- RMZ
- Skid trail
- Wetland
- County Forest Boundary
- Red Paint Line (RPL)
- Boat Launch
- Parking Lot
- Survey Corner
- Gate

Additional Regulations:

- In the Marked Hardwood Area:** Harvest all aspen, balsam fir and ironwood 1" DBH and larger, and all trees marked with orange paint leaving orange visible on the stump. No harvesting is allowed in the young aspen pockets outlined in green paint. Caution must be used to protect the limited hardwood regeneration. Excessive damage to regen may result in further equipment restrictions (such as no hot saws or fixed head harvesters only), or contract cancellation. Slash must be evenly distributed across sale area (no large piles). Slash should not be concentrated in canopy gap areas. NO WHOLE TREE OR POLE LENGTH SKIDDING. Utilization on all species is a 100" stick to a 4" top. Any den or nest trees shall be left uncut. Standing dead trees are not to be cut unless they pose a safety hazard. Do not damage the survey monument in the SW corner of the sale or any trees with blue paint on them.
- Dry or frozen ground conditions will be required for harvesting and hauling activities. Harvesting/skidding in the harvest area is limited to July 15th through the following spring break-up (approx March 15th). Further seasonal restrictions may be imposed if excessive rutting occurs in the woods, the roads, or if excessive damage to the residual trees occurs.
- No new roads are permitted except for access from the south (1). Existing roads may be opened and improved and landing sites may be constructed with prior approval of the County. The gate on the access road connecting to the parking lot must be kept closed when no one is on site. All trails must be returned to their original condition or better at the end of sale. Bond money will not be returned until all road/landing rehabilitation is satisfactorily complete.
- No equipment is allowed in the wetland areas within or adjacent to the sale unless the ground is frozen. No slash is to be left in any wetlands within or adjacent to the sale. Equipment may not be operated within 15 ft of any wetland unless ground is dry or frozen.
- Slash must be pulled back 10 ft off the edge of the parking lot and cut to less than 2 ft high within 25 ft of it. The parking lot and Johns Memorial Dr must be repaired to the satisfaction of the county if either is used for skidding, decking, or hauling. This may include graveling.
- If the parking lot is used for decking, caution signs must be installed at the entrance. The lot shall be restored to as good or better condition once the sale is complete and be kept in good condition on a daily basis. This may include graveling. If decking occurs on the parking lot, decks must be placed far enough off the edge of the lot so as not to pose a hazard to users. Debris must be removed from the parking lot daily.
- There has been a RMZ established on the north edge of the sale designated by red paint. No trees are to be cut within the RMZ.
- All items listed in the Oneida County Timber Sale Contract apply. All applicable BMP's will be followed. Sale Est. JF/WDNR 8/23